

Bowen St. was laid out Oct. 1851, upon petition of the abutters and it appears that the petitioners furnished the plan (81<sup>916</sup>) which was made by Schubarth & Haines. Most of the landmarks mentioned have disappeared and the lines recommended hereon are fixed by the northeast corner of the house owned by Jonathan Slocum in 1851, (S.E. cor. of Bowen & Prospect Sts.), the location of the curbstones at the crossing of Prospect St., the northeast corner of Albert Dailey's lot in 1851 as surveyed by Geo. C. Tingley in 1881 (See Recorder's card 539) and the location of curbstones at Hope St. - See lines run by F.B. Bourne in Nov., 1881, (Field book VII p.10 to 14) and in 1886. (Field book XI, p. 4.) Also those run by L.E. Baker in fall of 1912. Field book 1674, pp. 148-151.

Scale 80 feet per inch.

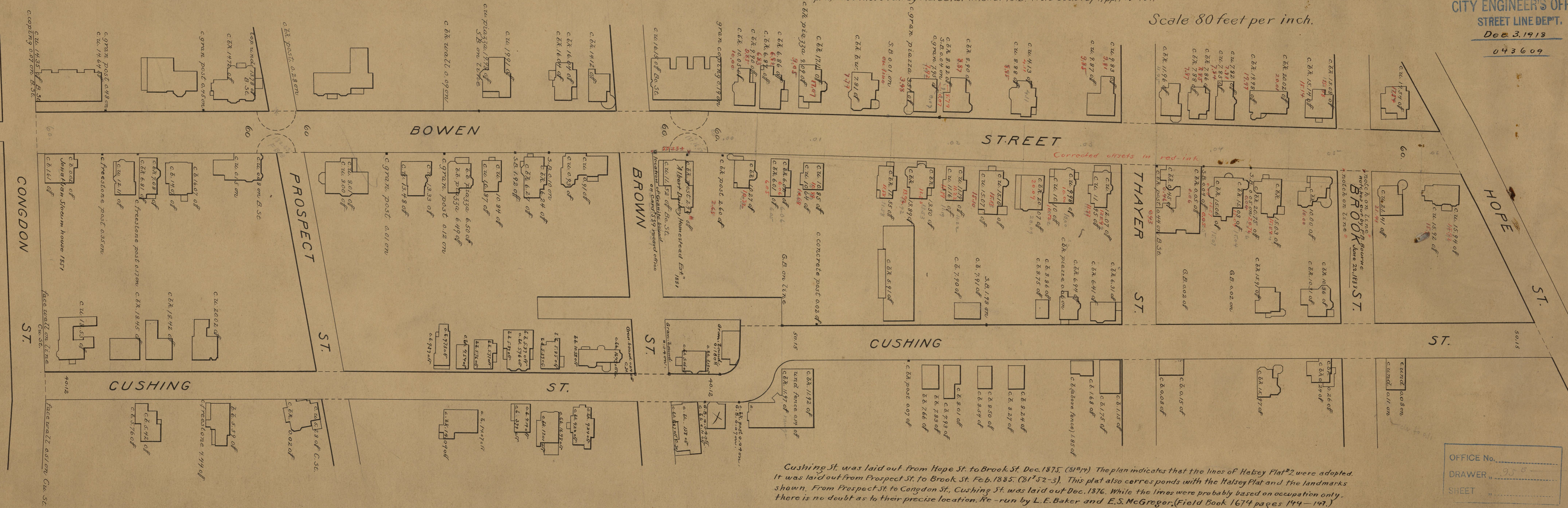

Cushing St. was laid out from Hope St. to Brook St. Dec. 1875. (81<sup>914</sup>) The plan indicates that the lines of Halsey Plat #2 were adopted. It was laid out from Prospect St. to Brook St. Feb. 1885. (81<sup>52-3</sup>) This plat also corresponds with the Halsey Plat and the landmarks shown. From Prospect St. to Congdon St., Cushing St. was laid out Dec. 1876. While the lines were probably based on occupation only, there is no doubt as to their precise location. Re-run by L.E. Baker and E.S. McGregor. (Field Book 1674 pages 144-147.)

OFFICE No. \_\_\_\_\_  
 DRAWER " 93 "  
 SHEET " \_\_\_\_\_