

Bridge connecting two points of
Smithfield Ave.

Preserve temporary

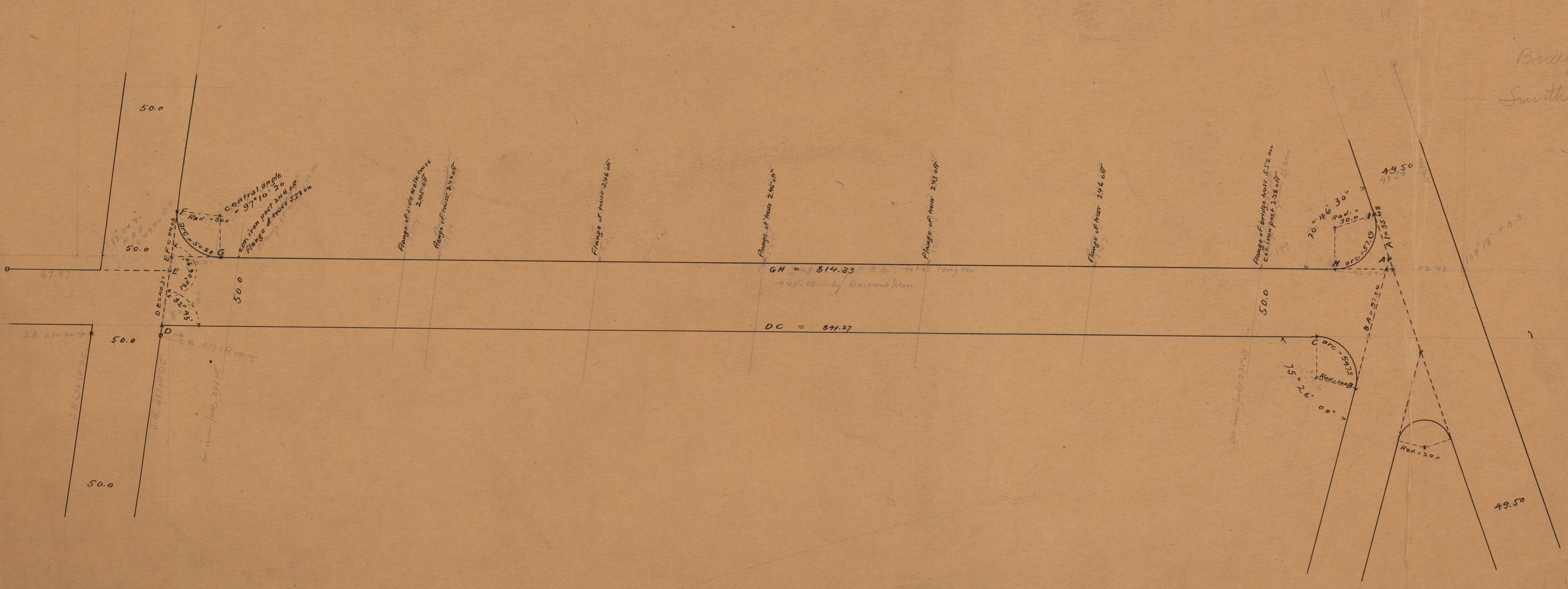

GH = 814.33
 943.01 by Railroad plan
 DC = 844.27

sin 70° 46'	0.624943	
47.50	1.674605	
	1.719548	
109.14		= 524.26
2) 70.96		42.24
35.23 cut	0.148604	128.68
30.0	1.477121	814.33
	1.625725	943.01
		= 42.24
2) 82.48 40		
41.24 50 cut	0.054507	
30	1.477121	
	1.531628	
943.01		= 34.01
128.68		
814.33		

Cemetery Street
 connecting two points of
 Smithfield Ave.