

Bridge connecting two portions of
Smithfield Ave.

Traverse temporarily

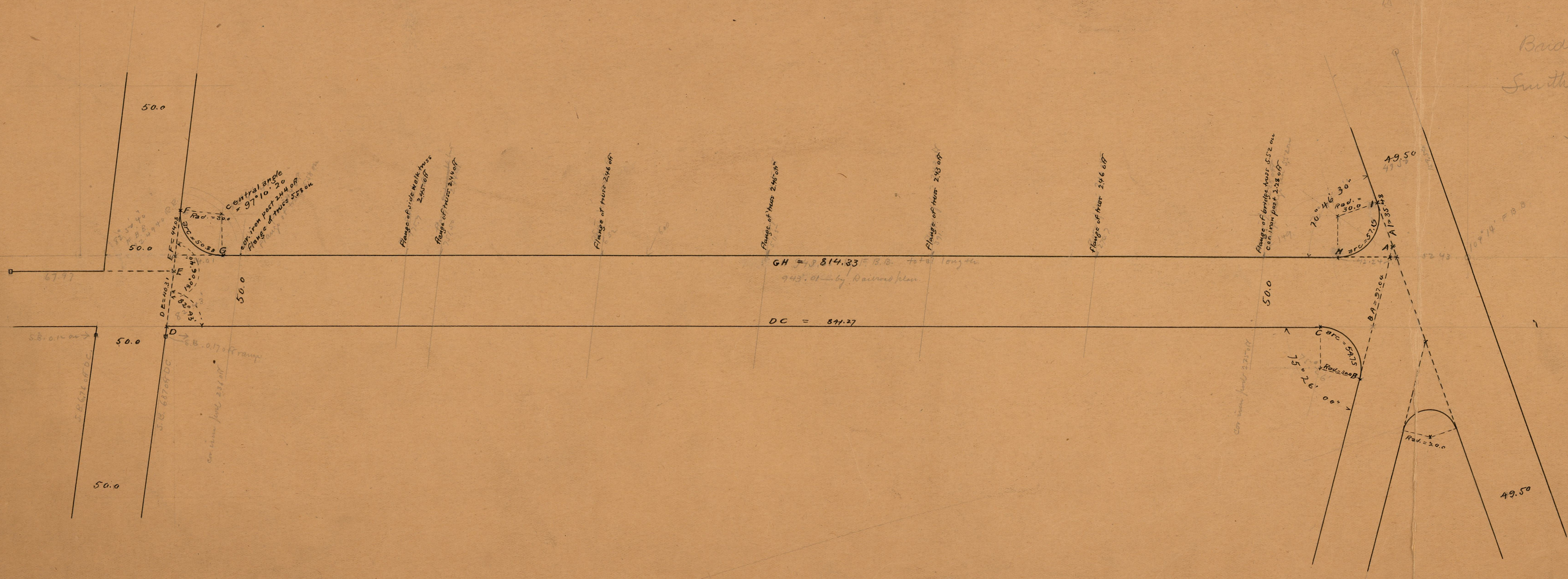

| | | |
|--------------|----------|----------|
| sin 70° 46' | 0.624943 | |
| 4950 | 1.674605 | |
| | 1.719548 | |
| 109.14 | | = 524.26 |
| 470.96 | | 42.24 |
| 35.28 cut | 0.148604 | 37.015 |
| 30.0 | 1.477121 | 128.65 |
| | 1.625725 | 814.33 |
| | | 42.24 |
| 482.49 | | |
| 41.24 50 cut | 0.054507 | |
| 50 | 1.477121 | |
| | 1.531628 | |
| 943.05 | | = 34.012 |
| 128.65 | | |
| 814.33 | | |

Cemetery Slab
connecting two portions of
Smithfield Ave.