

In Two Sheets-Sheet One

Plat of

BRIDGHAM STREET

From Elmwood Ave. to Westminster St.

(Portion on Easterly Side)

City Council

October 5, 1970

Scale: 1" = 80'

PROVIDENCE, R. I.
 P. V. DEPT. - ENGINEERING OFFICE
 STREET LINE SECTION
 Plan No. 063453
 Date April 9, 1971

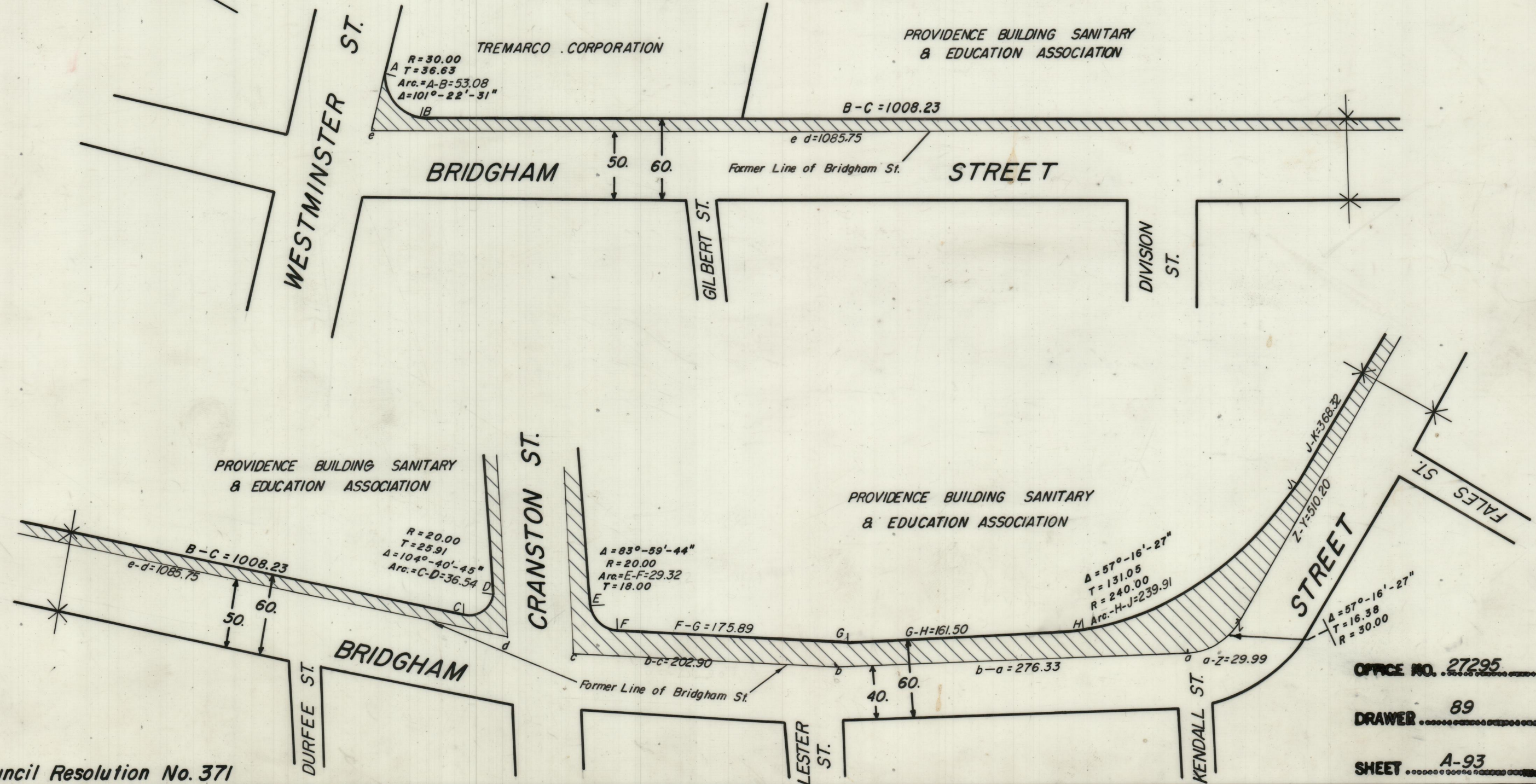
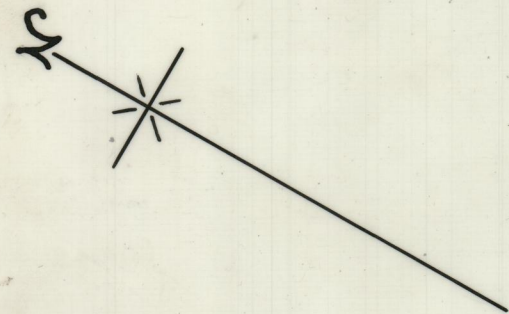

City Council Resolution No. 371

OFFICE NO. 27295
 DRAWER 89
 SHEET A-93