

PROVIDENCE, R. I.
 P. W. DEPT. - ENGINEERING OFFICE
 STREET LINE SECTION
 Plan No. 063084
 Date March 17, 1967.

PLAT OF

VIRGINIA LANE

From Douglas Ave. To The Easterly Line Of Glasgow St.

City Council

May 11, 1965

Scale 1" = 60'

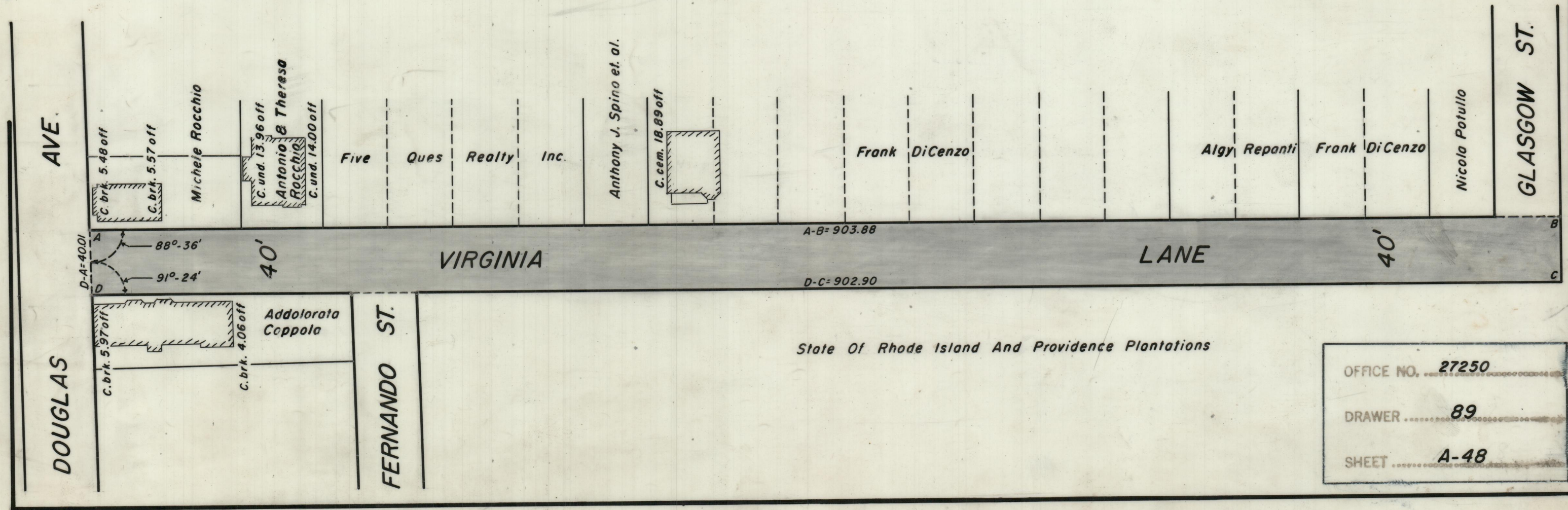
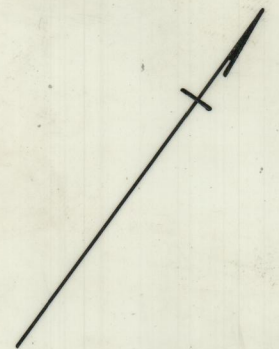

State Of Rhode Island And Providence Plantations

OFFICE NO. 27250
 DRAWER 89
 SHEET A-48