

PLAT OF

JASPER STREET

From The Portion Previously Received East Of Parente St. To A Point Square Opposite The Tangent Point Of A Curve At The North - Easterly Corner Of DiMario Drive And Jasper Street.

CITY COUNCIL AUGUST 17, 1964

SCALE 1"=40'

PROVIDENCE, R. I.
ENGINEERING OFFICE
STREET LINE SECTION
Plan No. 062733
Date JAN. 28, 1965

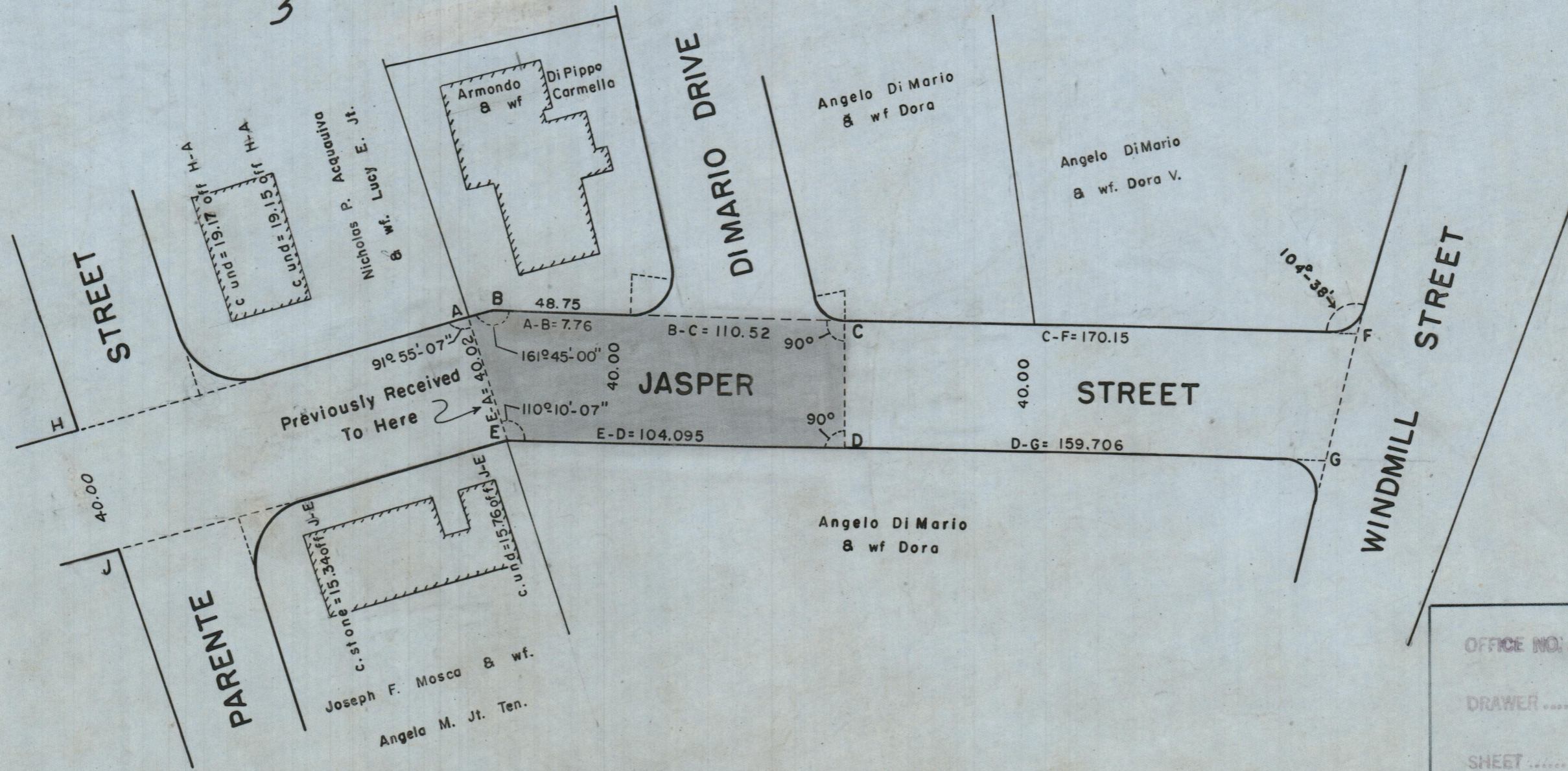
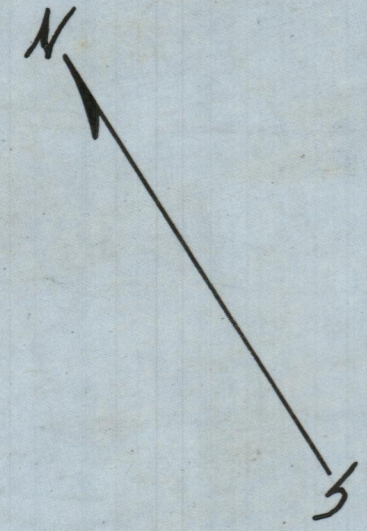

OFFICE NO. 27223
DRAWER 89
SHEET A21