

75-21

79

FB 3283

PLAT OF

# MIDDLE DRIVE

From GENERAL ST. To ADMIRAL ST

CITY COUNCIL

November 3, 1953

PROVIDENCE, R. I.  
 P. W. DEPT. - ENGINEERING OFFICE  
 STREET LINE SECTION  
 Plan No 061275  
 Date September 27, 1955

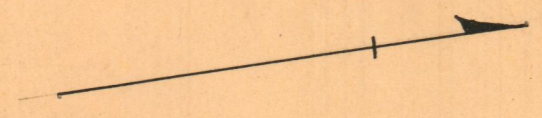

SCALE 1" = 60'

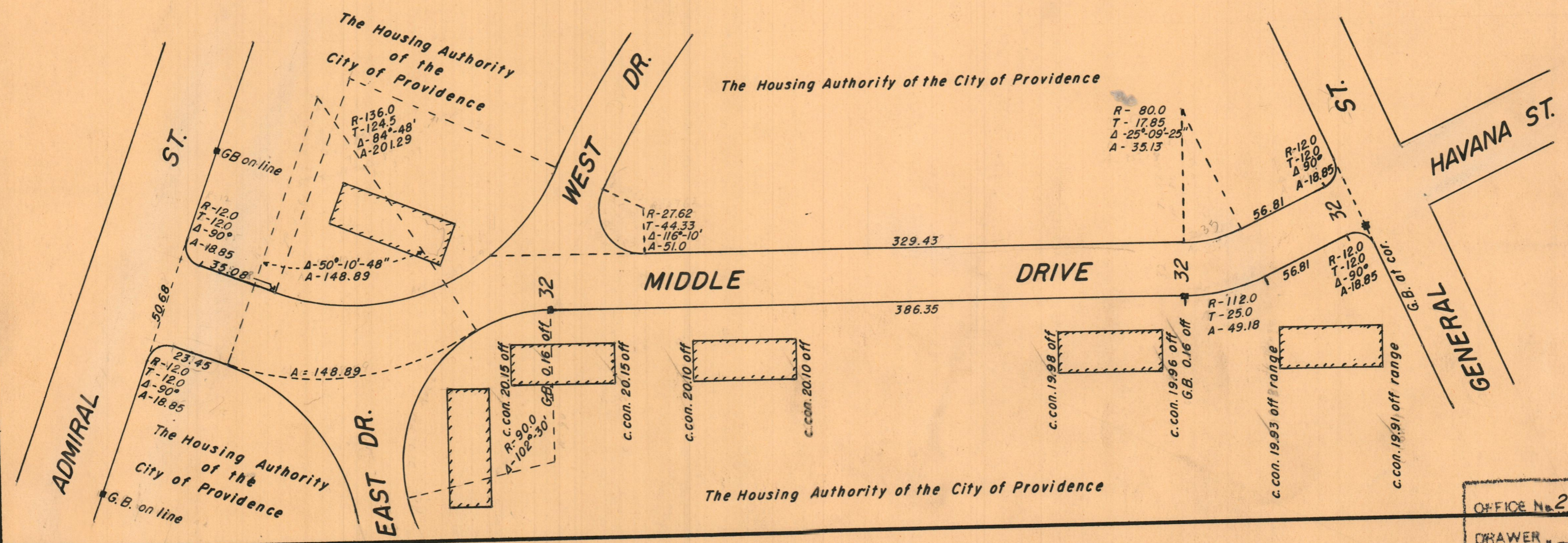

OFFICE No. 26 988  
 DRAWER 88  
 SHEET B-69