

PLAT OF FORSYTH STREET

From COGGESHALL ST. TO MOWRY ST.

CITY COUNCIL
MARCH 7, 1952

PROVIDENCE, R. I.
P. W. DEPT. - ENGINEERING OFFICE
STREET LINE SECTION
Plan No. 060660
Date JANUARY 14, 1953

SCALE 1" = 40'

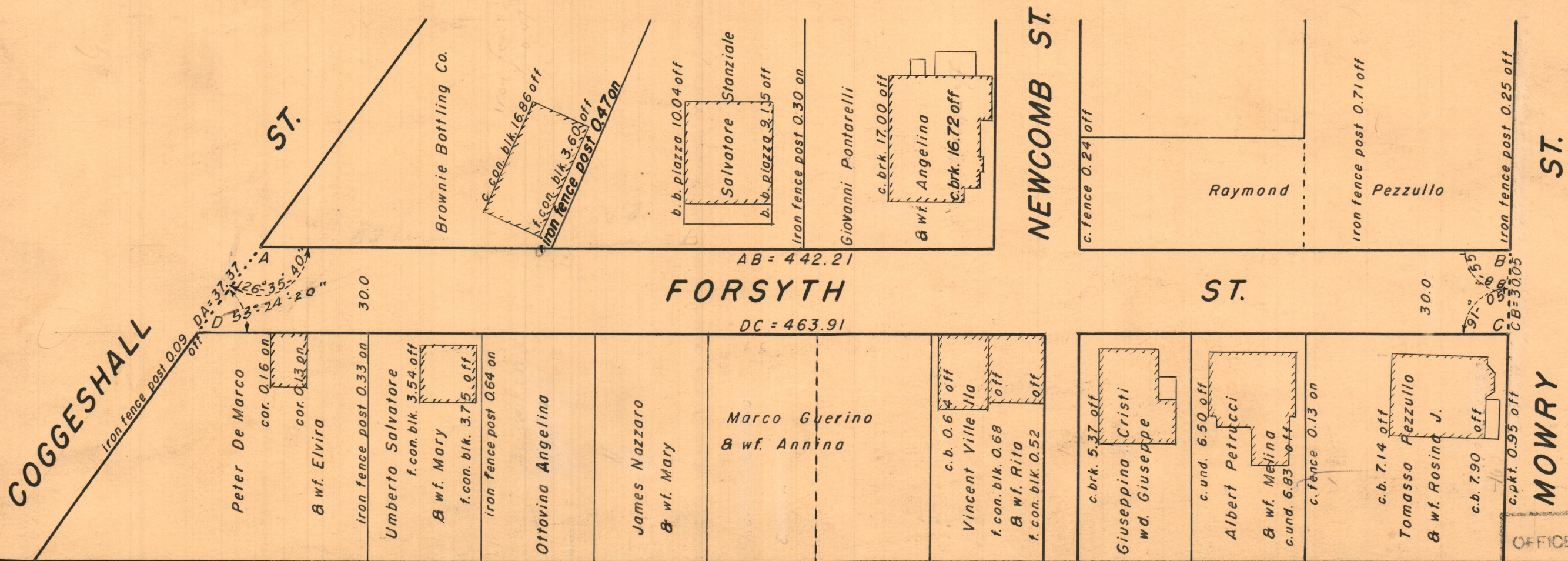
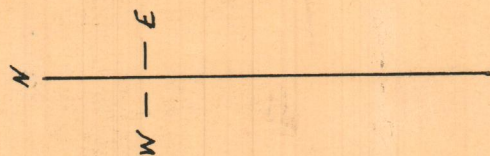

AB = 442.21
DC = 463.91

COGGESHALL ST.

NEWCOMB ST.

MOWRY ST.

OFFICE No. 26909
DRAWER 88
SHEET A-40