

PLAT OF BRYANT STREET

FROM ALLSTON ST. TO REGENT AVE.
CITY COUNCIL
OCTOBER 5, 1951

PROVIDENCE, R. I.
P. W. DEPT. - ENGINEERING OFFICE
STREET LINE SECTION
Plan No. 060528
Date FEBRUARY 25, 1952.

SCALE 1" = 40'

190.00

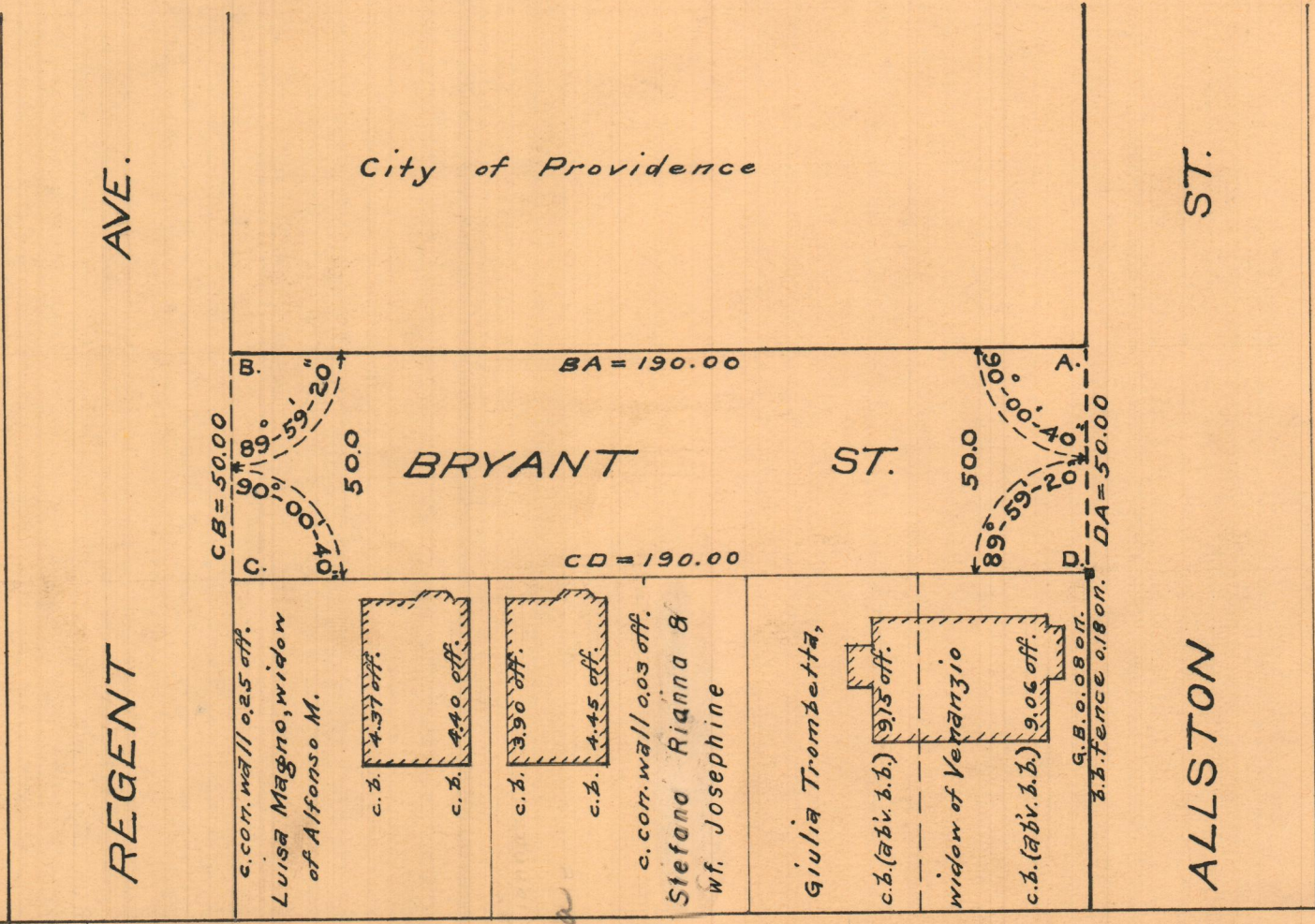
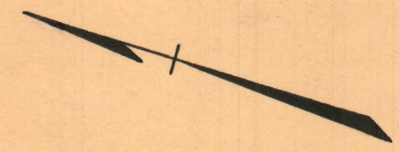

OFFICE No. 26892
DRAWER " 88
SHEET " A-23