

PLAT OF
TALLMAN STREET

FROM EDDY ST. TO THE HARBOR LINE
ABANDONED BY THE BOARD OF ALDERMEN
JANUARY 21, 1937.

PROVIDENCE, R.I.
CITY ENGINEER'S OFFICE
STREET LINE DEPT.
May 11, 1943
059258

SCALE 1" = 50'

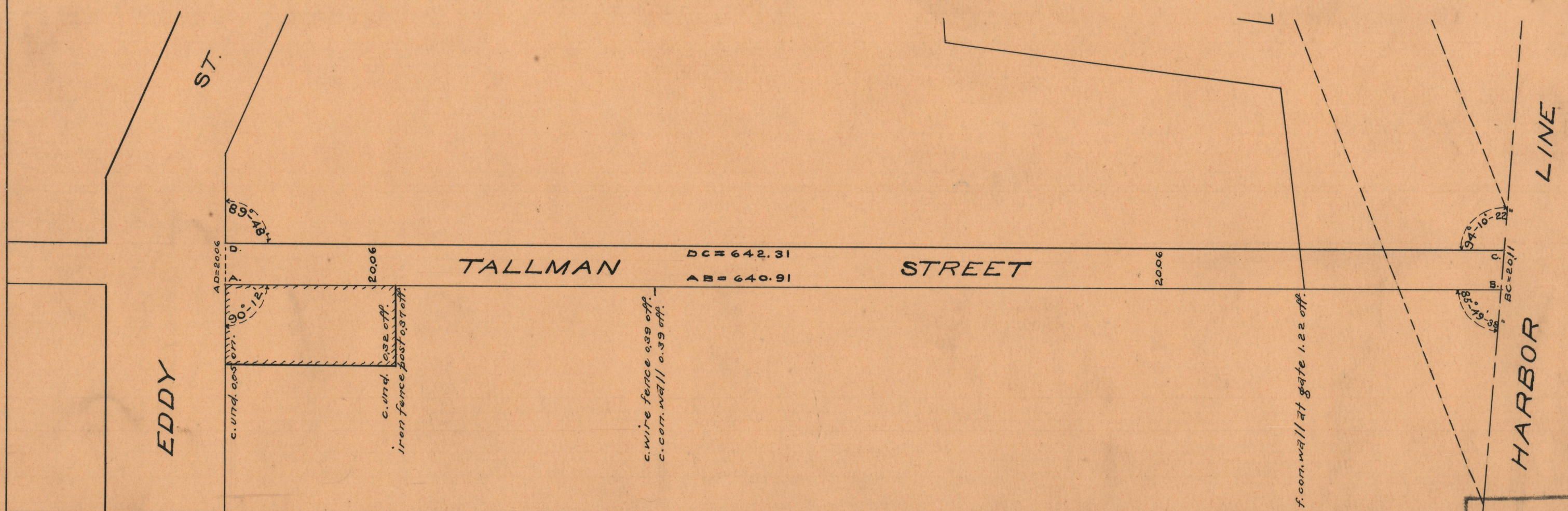
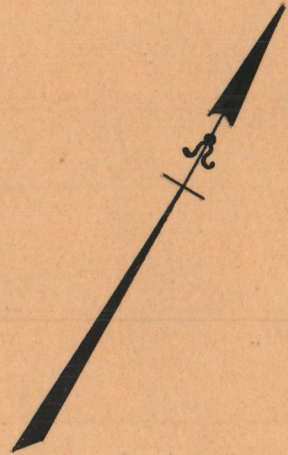

OFFICE No. 26776
DRAWER " 87
SHEET " C-9