

PLAT OF BURNS STREET

FROM ADMIRAL ST. TO HAVANA ST.

CITY COUNCIL

APRIL 2, 1948.

SCALE 1" = 50'

PROVIDENCE, R. I.
CITY ENGINEER'S OFFICE
STREET LINE DEPT.

MARCH 3, 1949

060001

FIGURES IN RED DENOTE NEW OFFSETS
SEE FB. 3406 P 66

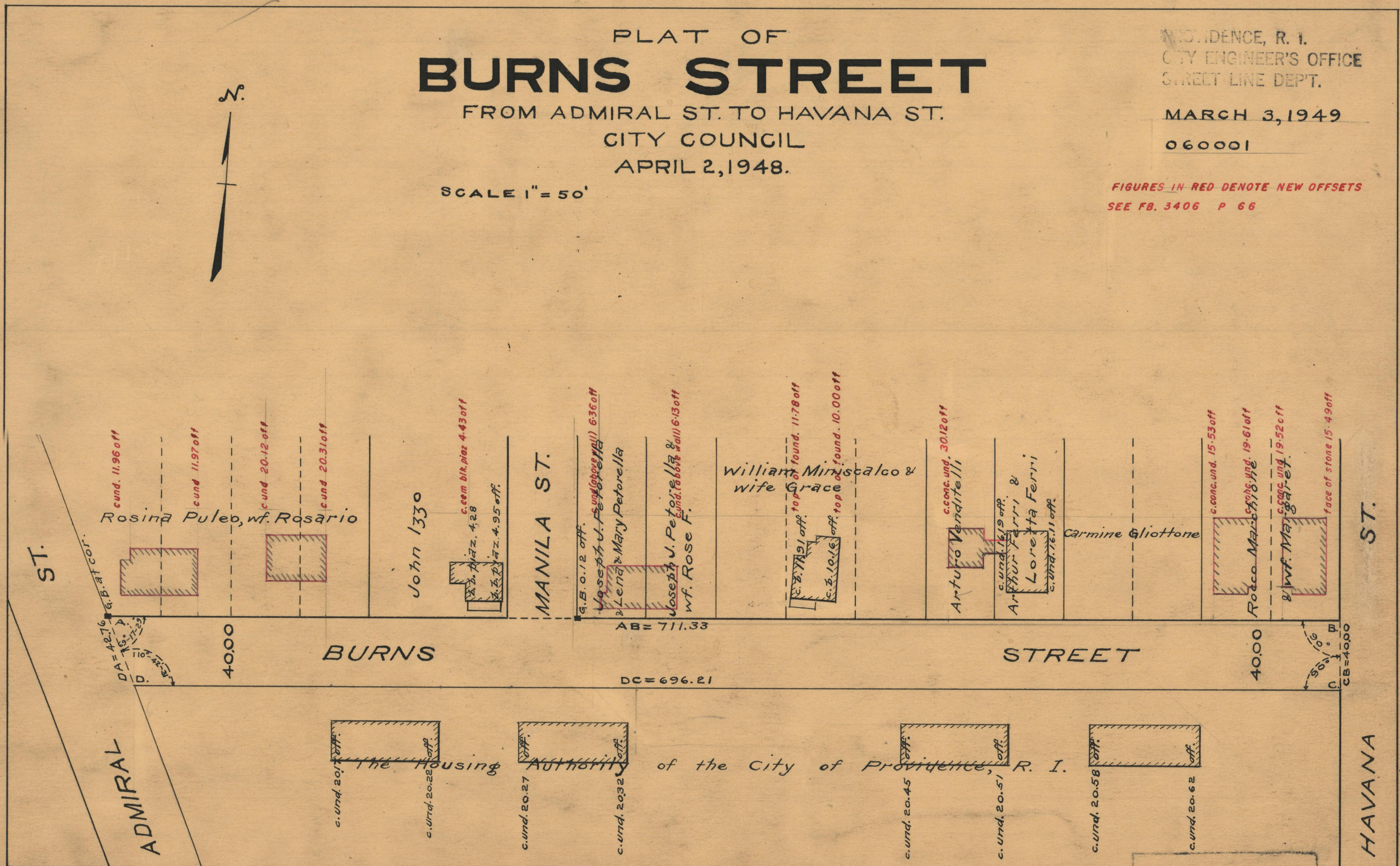
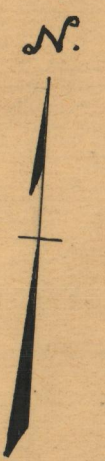

OFFICE No. 26790
DRAWER 87
SHEET C-21