

PLAT OF FIFTH STREET

FROM HIGHLAND AVE. TO SUMMIT AVE.

CITY COUNCIL
DECEMBER 17, 1943.

PROVIDENCE, R.I.
CITY ENGINEER'S OFFICE
STREET LINE DEPT.

Jan. 3, 1944.

059368

SCALE 1"=40'

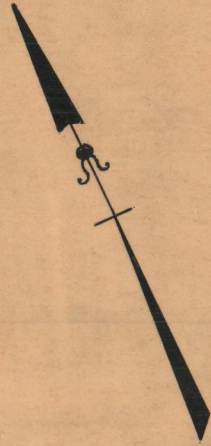

HIGHLAND AVE.

Jewish Orphanage Of R. I.

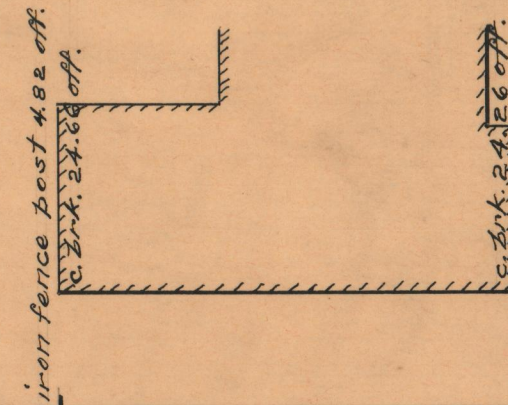

SUMMIT AVE.

iron fence post 4.95 off.
DA = 40.00

40.00

AB = 500.00

FIFTH

STREET

40.00

DC = 500.00

John T. Cottrell Co.

City of Providence

iron fence post 0.40 off.
G.B. 3.000 on.
G.B. = 40.00

G.B. 3.000 on.
c. fence 0.18 off.

HIGHLAND

SUMMIT

OFFICE No. 26782
DRAWER " 87
SHEET " C-15