

PROVIDENCE, R.I.
CITY ENGINEER'S OFFICE
STREET LINE DEPT.

Jan. 13, 1942.

059070

PLAT OF
JUNE STREET
FROM PUMGANSETT STREET TO CHAD BROWN STREET
CITY COUNCIL
DECEMBER 6, 1941.
SCALE 1" = 40'

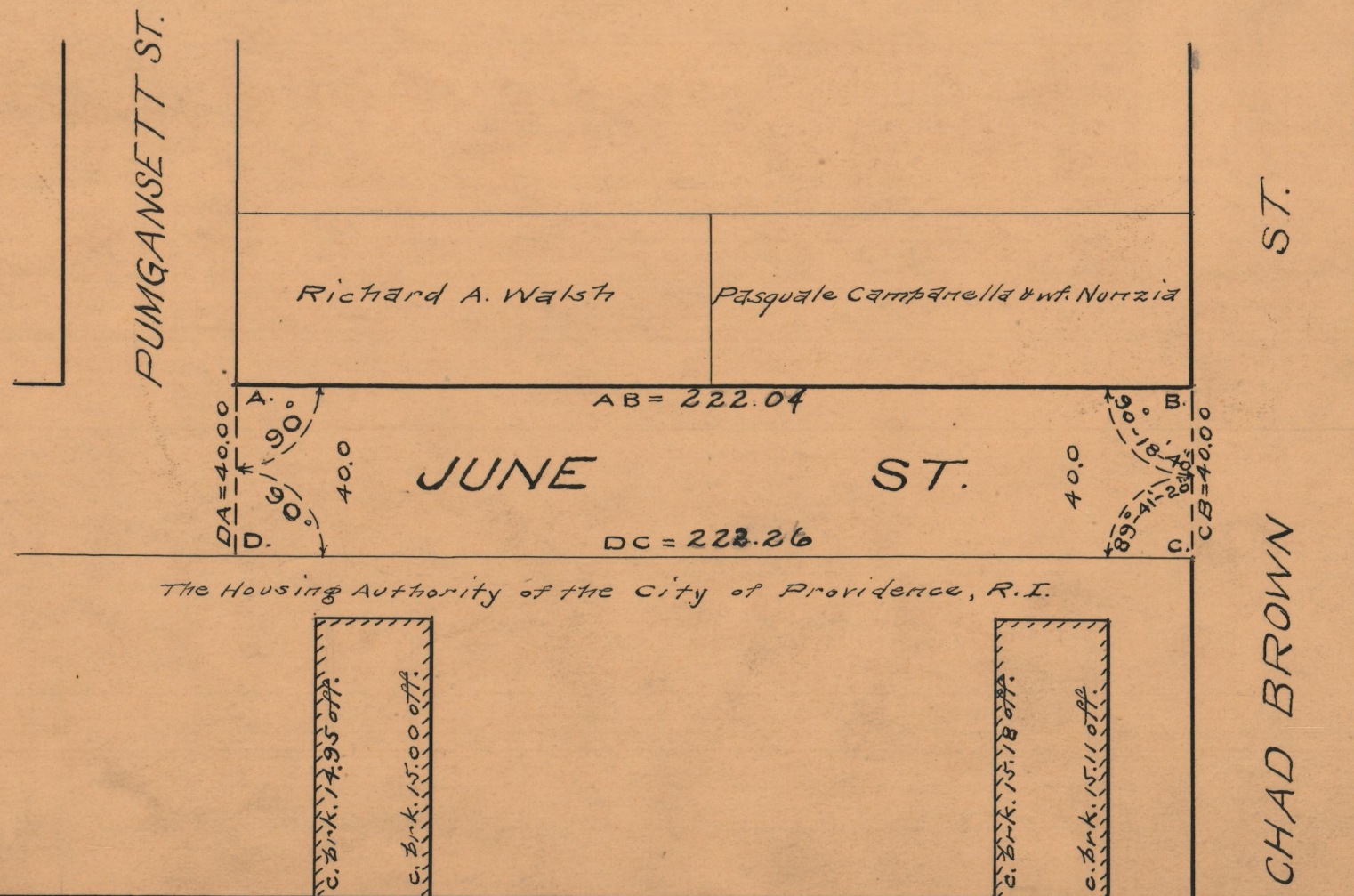
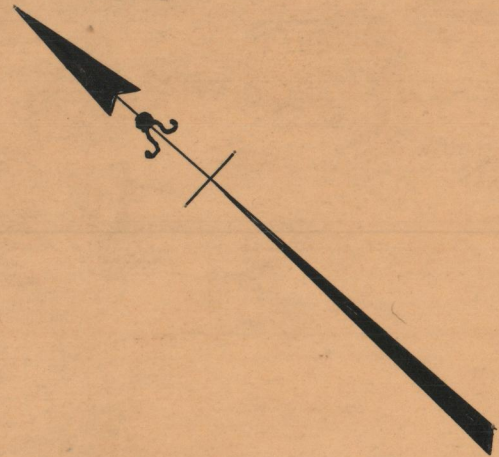

OFFICE No.	26752
DRAWER	87
SHEET	B-85