

PLAT OF RANKIN AVENUE

CITY ENGINEER'S OFFICE
STREET LINE DEPT.
Feb. 1, 1941.
058821

IN TWO SHEETS

FROM PLEASANT VALLEY PARKWAY TO WHITFORD AVE.

BOARD OF ALDERMEN

DECEMBER 5, 1940



SCALE 1 INCH = 50 FT.

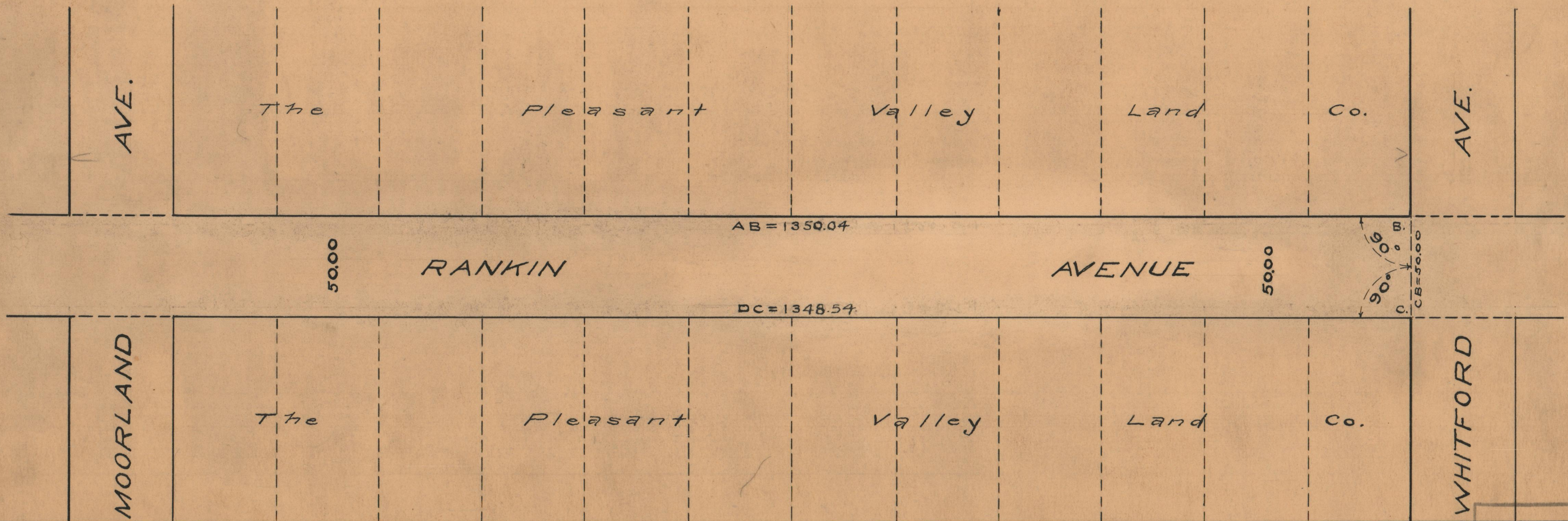

| | |
|------------|-------|
| OFFICE No. | 26739 |
| DRAWER | 87 |
| SHEET | B-73 |