

PLAT OF
HAVANA STREET
FROM THE SOUTHERLY LINE OF BURNS ST. TO LUBEC ST.
BOARD OF ALDERMEN
JUNE 16, 1938.

PROVIDENCE, R. I.
CITY ENGINEER'S OFFICE
STREET LINE DEPT.
Mar. 3, 1939
057949

SCALE 1" = 40'

200.00

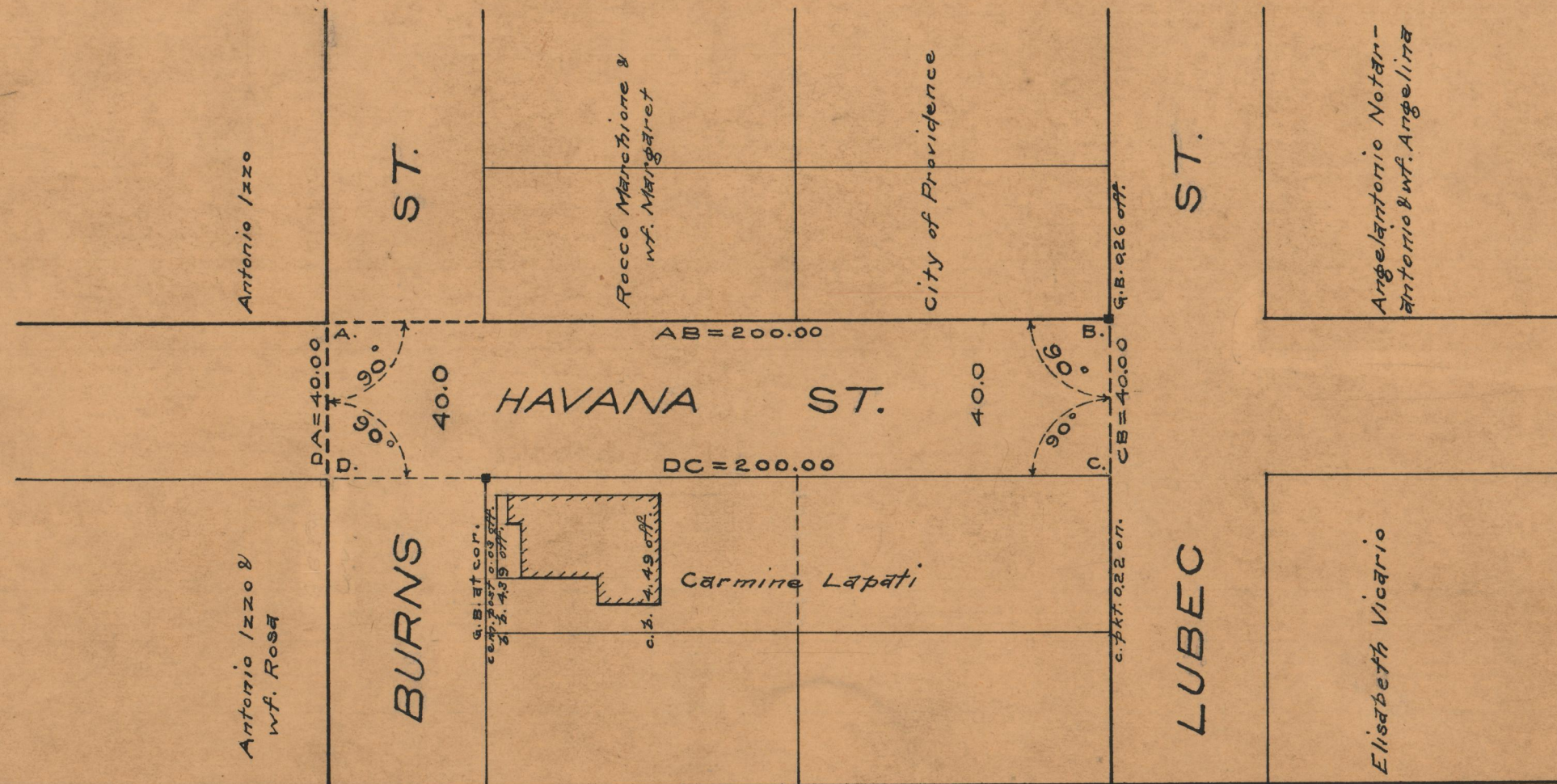
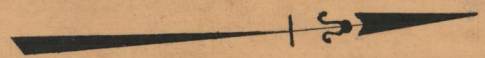

OFFICE No	26691
DRAWER	87
S	B-56