

# PLAT OF GENERAL STREET

IN THREE SHEETS  
FROM HAZAEL ST. TO ADMIRAL ST.  
BOARD OF ALDERMEN  
JUNE 16, 1938.

STREET LINE DEPT  
Jan. 26, 1939  
057901

SCALE 1" = 40'

1743.92  
1660.58  
2) 3404.50  
1702.25



Thomas A. Comstock &  
wf. Alice E.

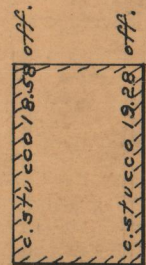

Anthony De Cesare  
gran. blk. 0.56 ac.

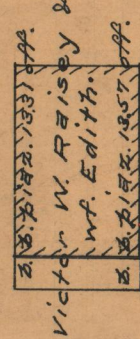

Edith Railey

gran. blk. 0.250 ac.

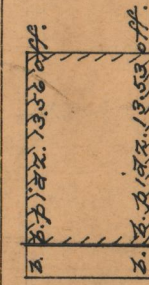

John L. McGuire

c. gran. blk. wall 0.56 off.

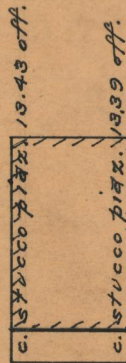

Alfred E. Millard Jr.  
& wf. Fanny

c. com. wall 0.75 off.

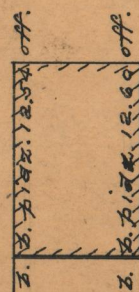

James F. Corboy &  
wf. Agnes R.

c. gran. wall 0.010 ac.

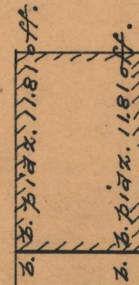

Edward J. Hart & wf.  
Elizabeth A.

c. fence 0.460 ac.

Mary G. Leary

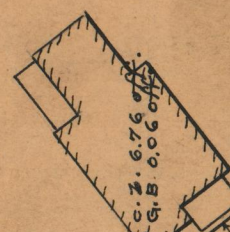

40.0

GENERAL STREET

BA = 1743.92

STREET

40.0

CD = 1660.58

Joseph Iacona

Antonetta Iacona

fence post 0.010 ac.  
John Iacona &  
wf. Antonetta

WAITE ST.

Angelina

Pusateri

HAZAEL ST.



DA = 78.195

187°-00'