

# PLAT OF ZELLA STREET

FROM ADMIRAL ST. TO BRADLEY ST.  
BOARD OF ALDERMEN  
MAY 19, 1938.

Dec. 23, 1938

057883

SCALE 1" = 50'

708.48  
698.34  
21406.82  
703.41

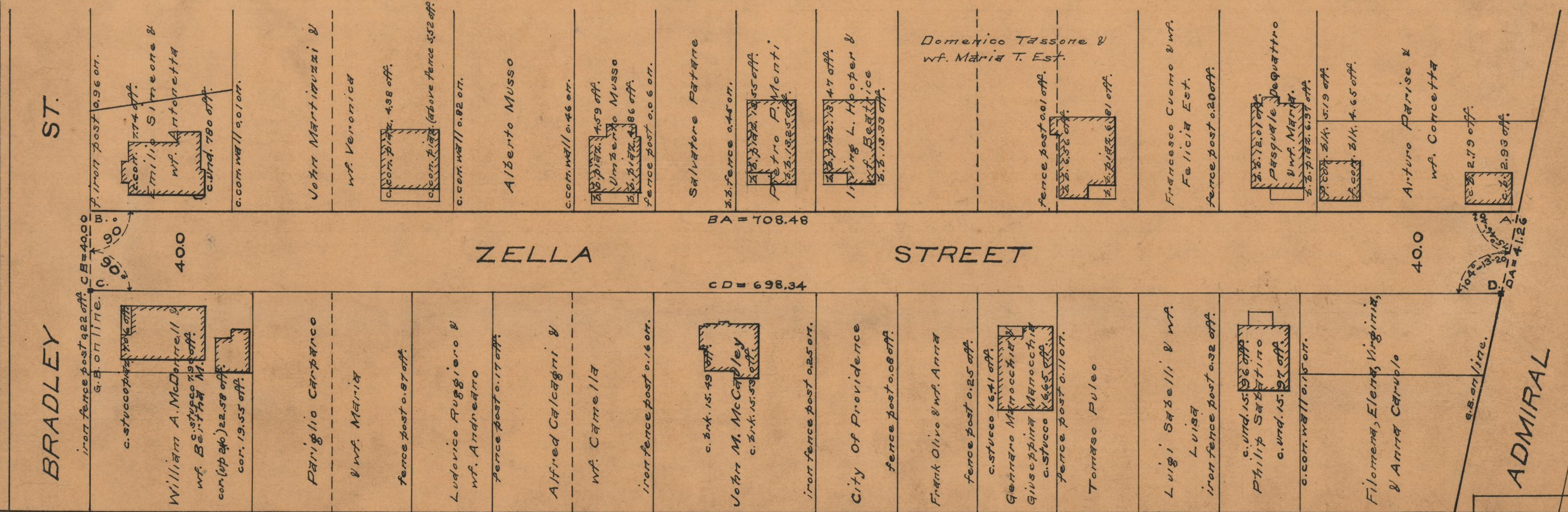
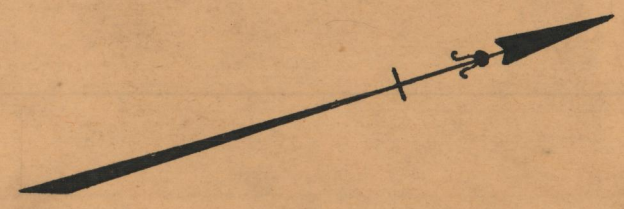

OFFICE No. 26678  
DRAWER 87  
SHEET B-47