

PLAT OF LOMBARDI STREET

FROM CHARLES ST. TO COMMODORE ST.

BOARD OF ALDERMEN

SEPTEMBER 19, 1935.

SCALE 1" = 40'

PROVIDENCE, R.I.
CITY ENGINEER'S OFFICE
STREET LINE DEPT.

Nov. 29, 1935

056566



385.78
383.10

2768.88
384.44

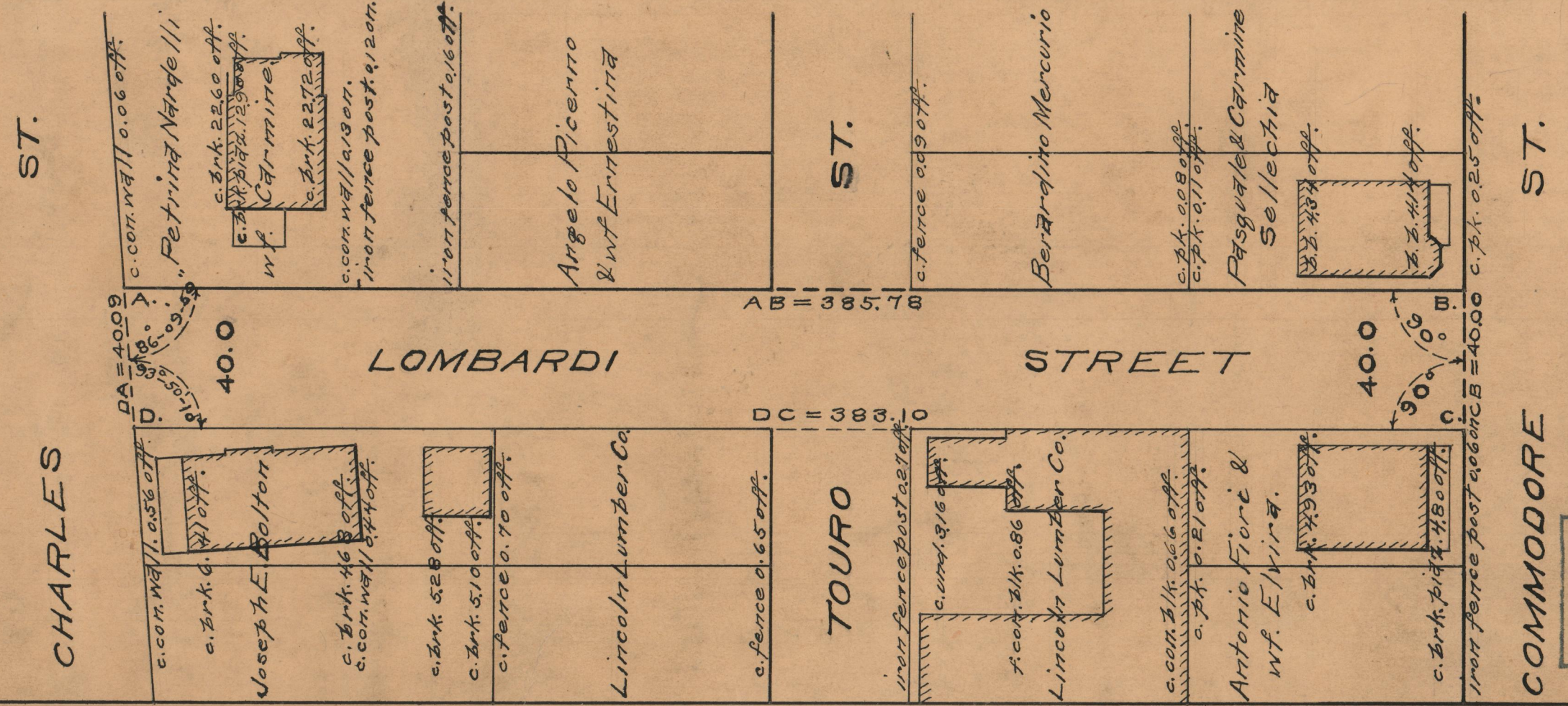

OFFICE No.	26511
DRAWER	87
SHEET	A-88