

# PLAT OF CLYDE STREET

FROM HEREFORD ST. TO LOVEDAY ST.

BOARD OF ALDERMEN

APRIL 16, 1931.

SCALE 1" = 40'

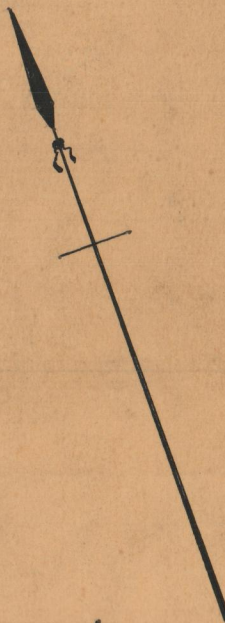

410.13  
395.83  
2/805.96  
402.98

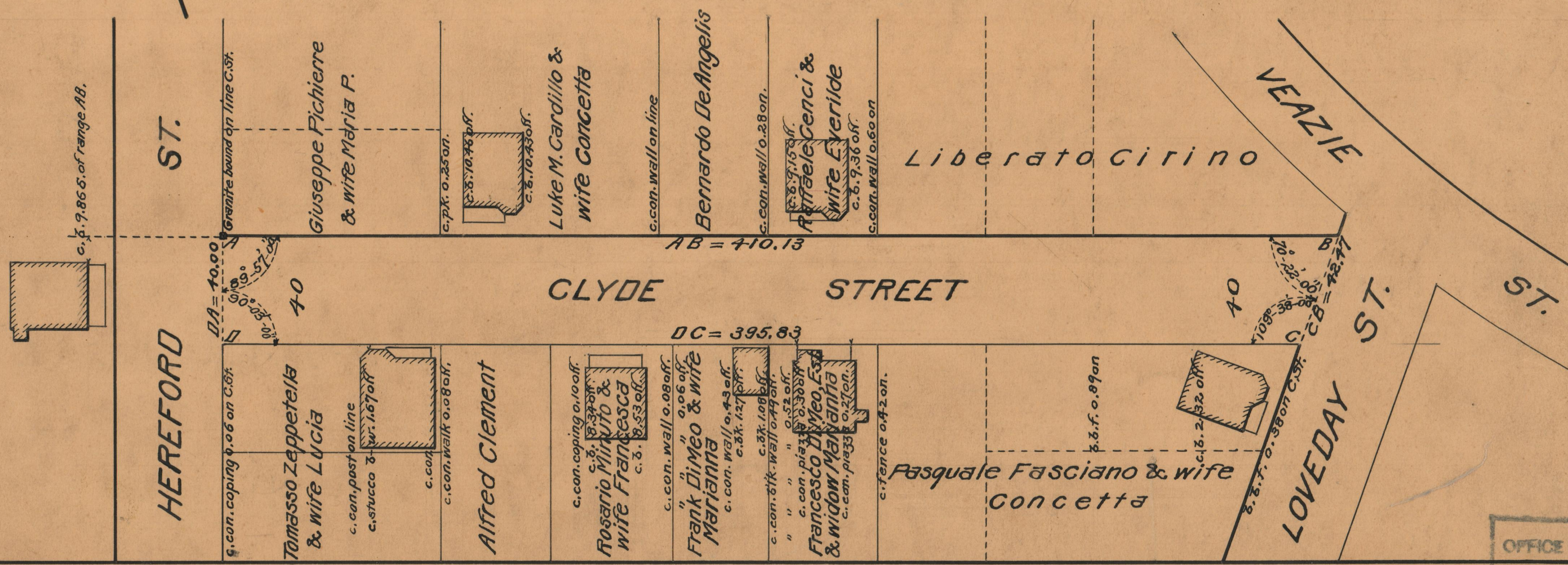

OFFICE No. 25539  
DRAWER 86  
SHEET C-40