

PLAT OF ALUMNI AVENUE

FROM HOPE ST. TO PENNINGTON AVE.
IN TWO SHEETS
BOARD OF ALDERMEN
May 15, 1930

PROVIDENCE, R.I.
CITY ENGINEER'S OFFICE
STREET LINE DEPT.
July 2, 1930
052861

Scale 1"=40'

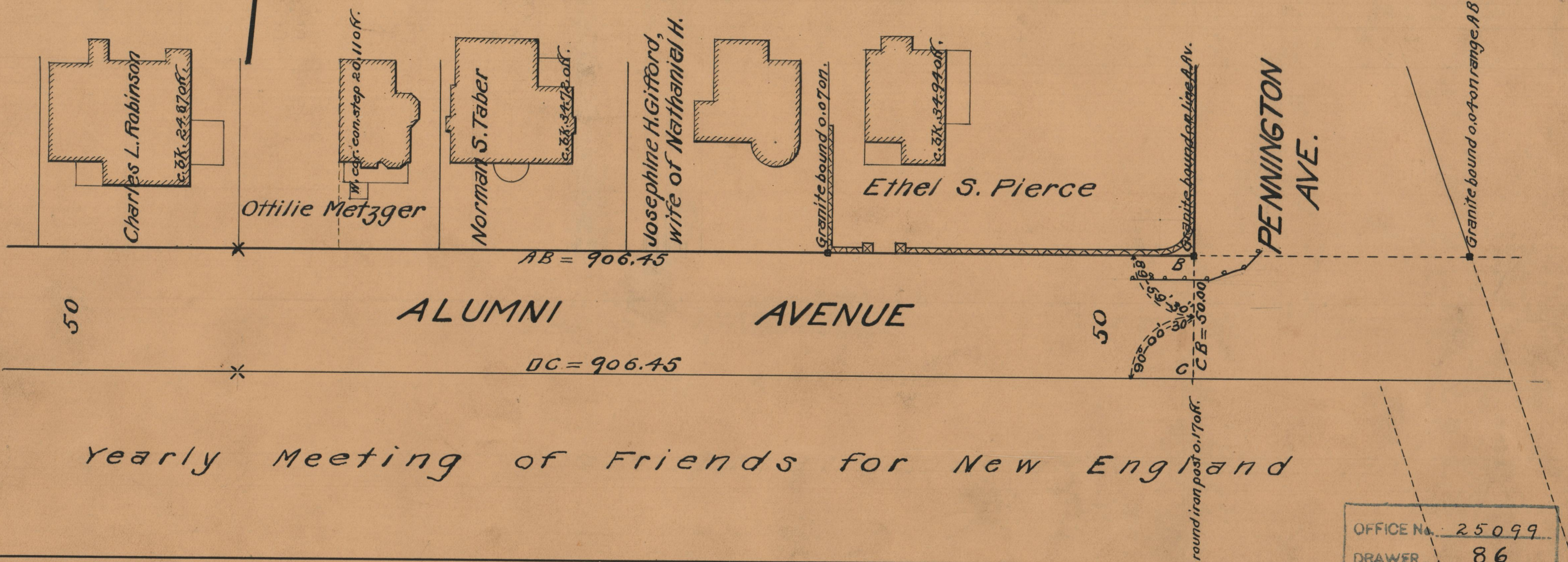

50

ALUMNI AVENUE

50

PENNINGTON AVE.

AB = 906.45

DC = 906.45

CB = 50.00

Yearly Meeting of Friends for New England

OFFICE No.	25099
DRAWER	86
SHEET	B-11