

SHEET TWO

G.W.S. 2690-158

PLAT OF

ROUNDS AVENUE

FROM

NARRAGANSETT AVE. TO ALEXANDER ST.

IN TWO SHEETS

BOARD OF ALDERMEN

JANUARY 16, 1930.

PROVIDENCE, R.I.
CITY ENGINEER'S OFFICE

STREET LINE DEPT.

Jan. 16, 1930.

052436

Scale 1"=40'

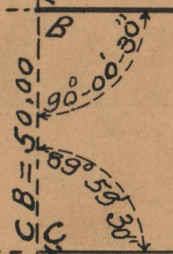
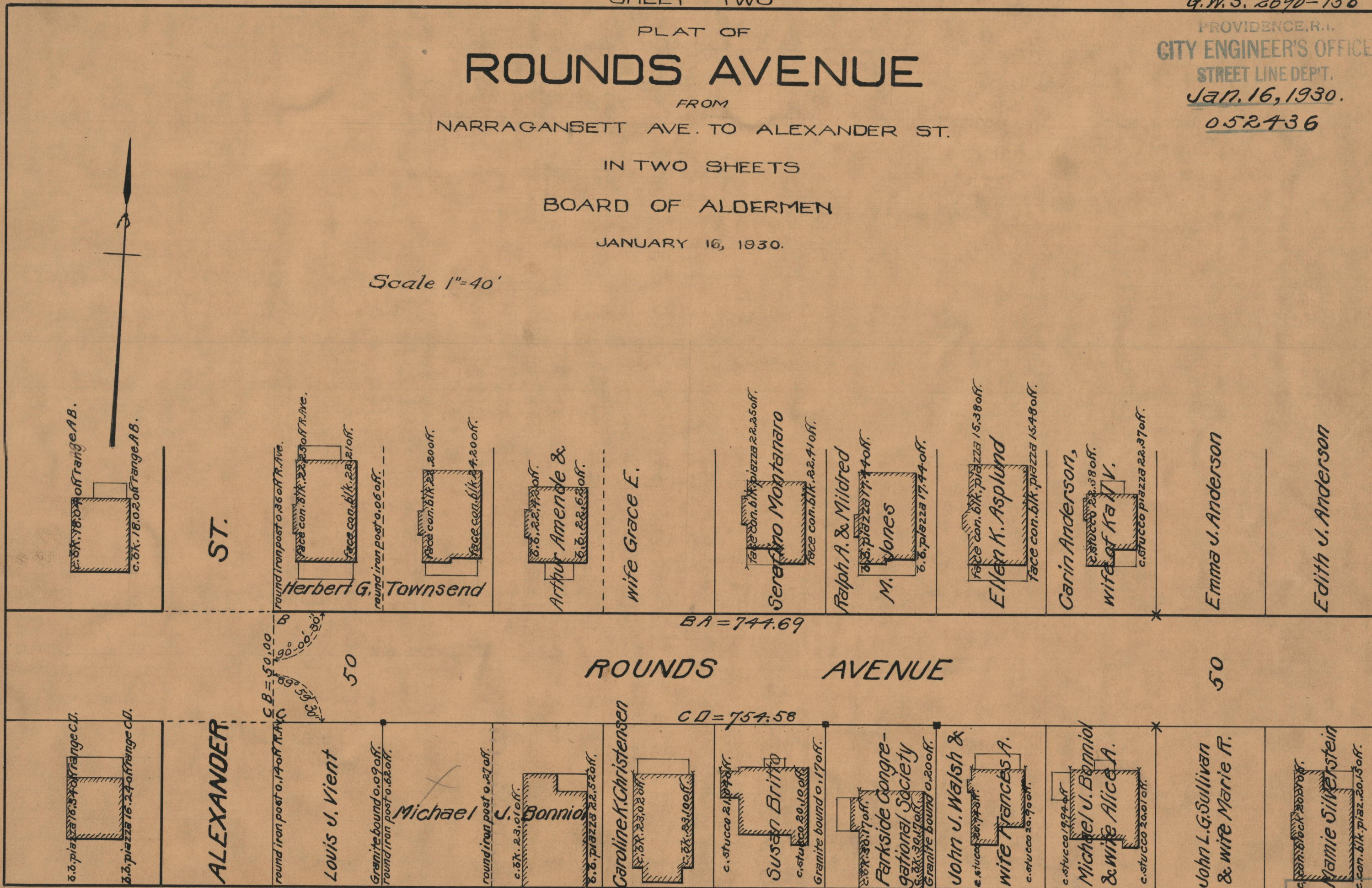

OFFICE No. 24990
 DRAWER No. 86
 SHEET No. A-83