

PLAT OF
KELLY STREET

FROM
 MAGNOLIA ST. TO PORTION RECEIVED
 BOARD OF ALDERMEN

DECEMBER 19, 1929

PROVIDENCE, R.I.
 CITY ENGINEER'S OFFICE
 STREET LINE DEPT.
Dec. 28, 1929.
 052358

Dec. 19, 1929

Scale 1" = 40'

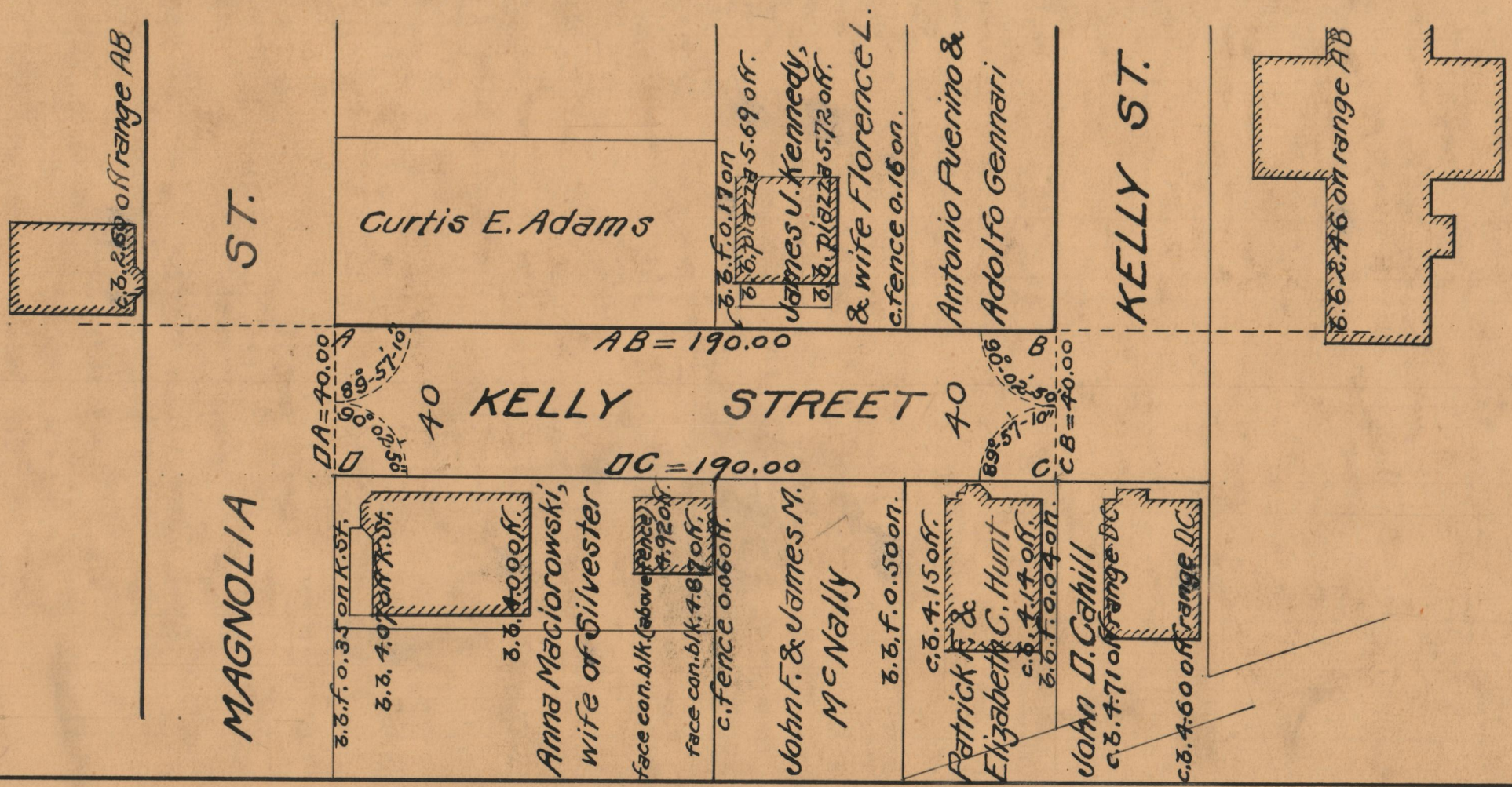
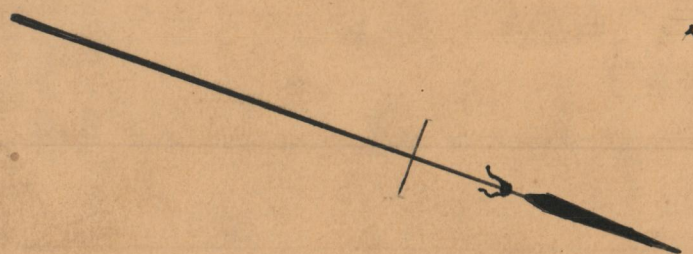

OFFICE No. 24934
 DRAWER 86
 SHEET A-77