

# PLAT OF CARR STREET

FROM BROAD ST. TO CACTUS ST.  
IN TWO SHEETS

SCALE 40 FEET PER INCH

DECLARED AND ESTABLISHED A PUBLIC HIGHWAY BY RESOLUTION  
OF THE BOARD OF ALDERMEN  
NOV. 15, 1928

PROVIDENCE, R.I.  
CITY ENGINEER'S OFFICE

STREET LINE DEPT.  
Nov. 15, 1928.

051205

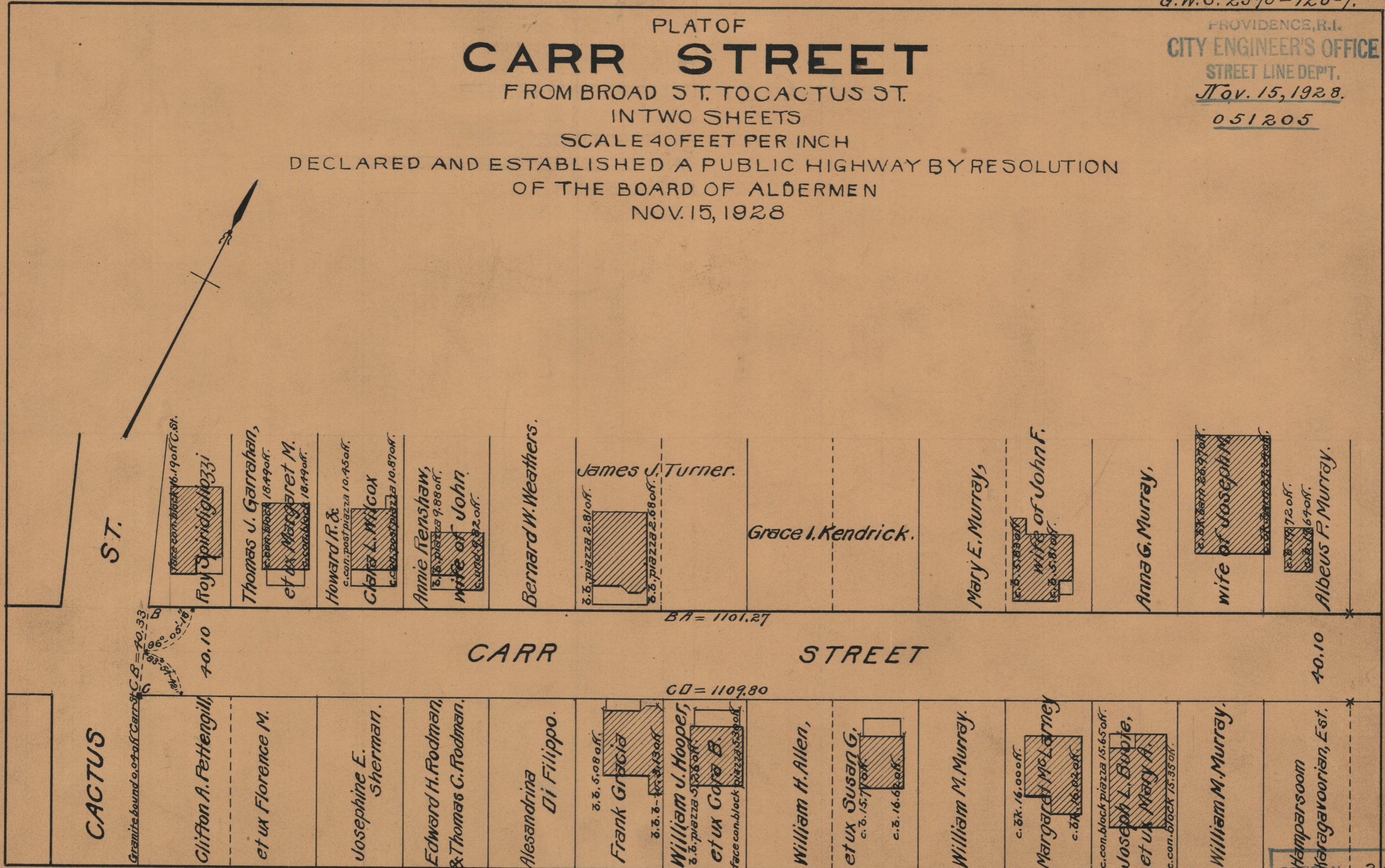

OFFICE NO. 27595  
 DRAWER 86  
 SHEET A-7