

Providence, R.I.
This plat accompanies
our report of this date.

PROVIDENCE, R. I.
CITY ENGINEER'S OFFICE
STREET LINE DEPT.

Aug 13, 1890

016765

PLAT OF
DABOLL STREET
FROM DEXTER ST. TO GREENWICH ST.

IN TWO SHEETS

SCALE 50 FEET PER INCH.



ST.

1/2" fence 0.07 on D. St.



AB = 1202.51 + 12.32 = 1190.19

Robert Knight

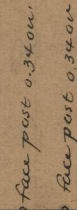

1/2" fence post 0.17 on D. St.

Ave. ST.

40.12

DABOLL STREET

40.12

GREENWICH

DC = 1207.61 + 12.32 = 1195.29

Face plat on 300 D. St.

BUCKLIN

con. fence 0.07 off D. St.

John Daboll

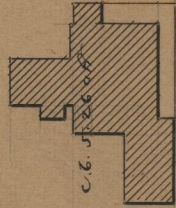

c. 6.5

Davis L. Daboll

c. post 0.28 off



Florida Daboll + Josephine Daboll

c. post 0.25 off

Francis W. Reynolds

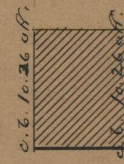

c. 6.10.26 off

c. fence 0.40 off

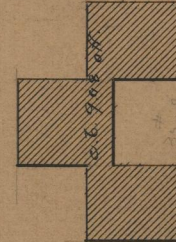

c. 6.40.28 off

c. 6.9.10.08

Chas. Sydney Smith

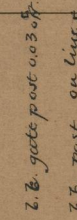

1/2" gate post 0.34 on

1/2" post on line

1/2" fence 0.17 on D. St.

GREENWICH



und. 1/2" off on D. St.

85
A-80

OFFICE No. 10527
DRAWER " 85
SHEET " 20