

FEB-27-73

PROVIDENCE, R. I.  
CITY ENGINEER'S OFFICE  
STREET LINE DEPT.

July 26, 1890  
016699

Providence, R. I.  
This plat accompanies  
our report of this date.

# PLAT OF DAHLIA STREET

FROM SALEM ST. TO DEXTER ST.

SCALE 40 FEET PER INCH.

*Changed to Waldo St. Feb. 19, 1892.*

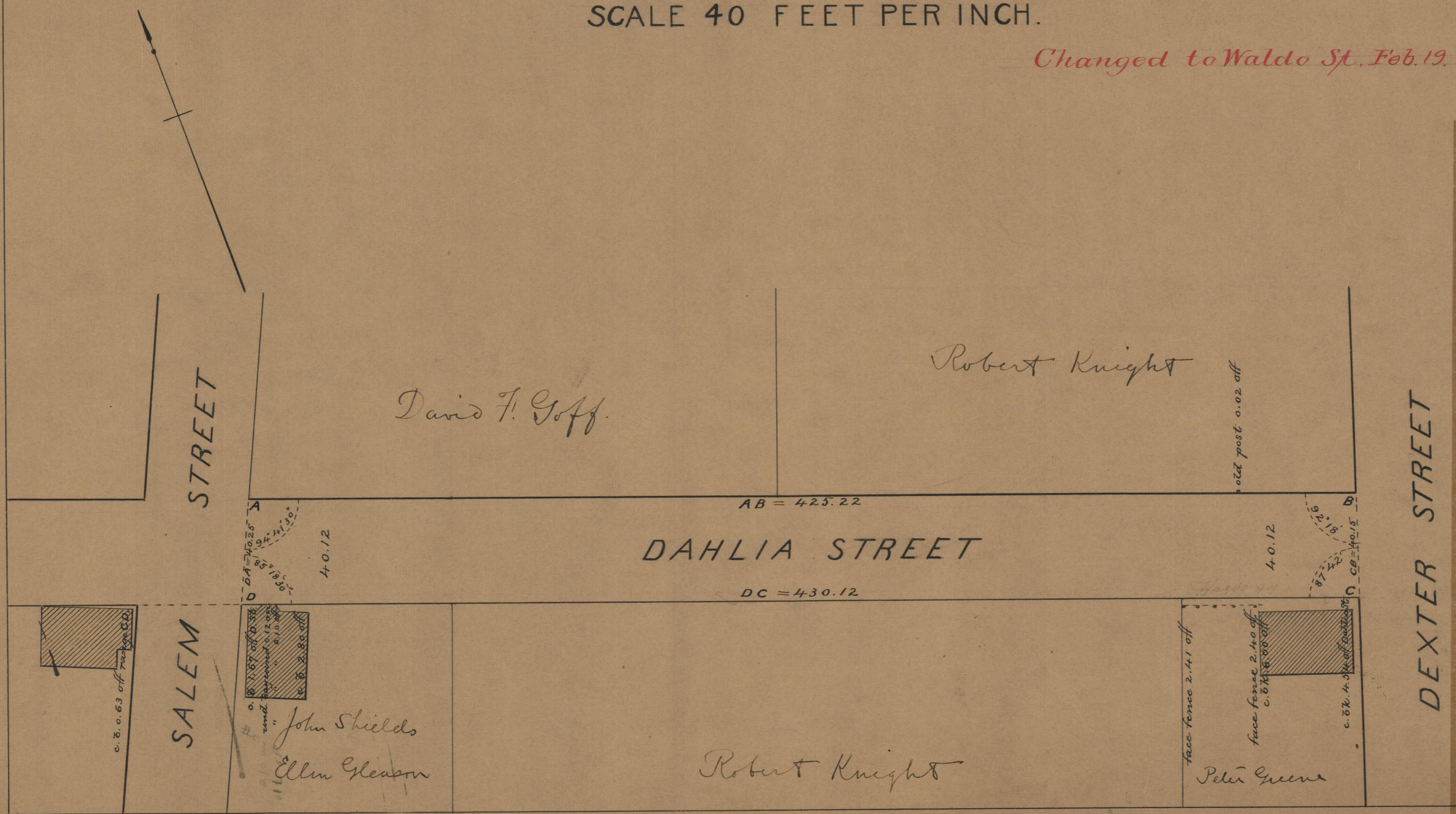

85  
A-76

85  
A-76

85  
A-76

OFFICE No.	10516
DRAWER	85
SHEET	1-76