

Providence R.I.
This plat accompanies
our report of this date

PROVIDENCE, R. I.
CITY ENGINEER'S OFFICE
STREET LINE DEPT.

Oct. 5, 1889

015531

PLAT OF
SLATER AVENUE
FROM IRVING AVE. TO PRESIDENT AVE.
SCALE 60 FEET PER INCH

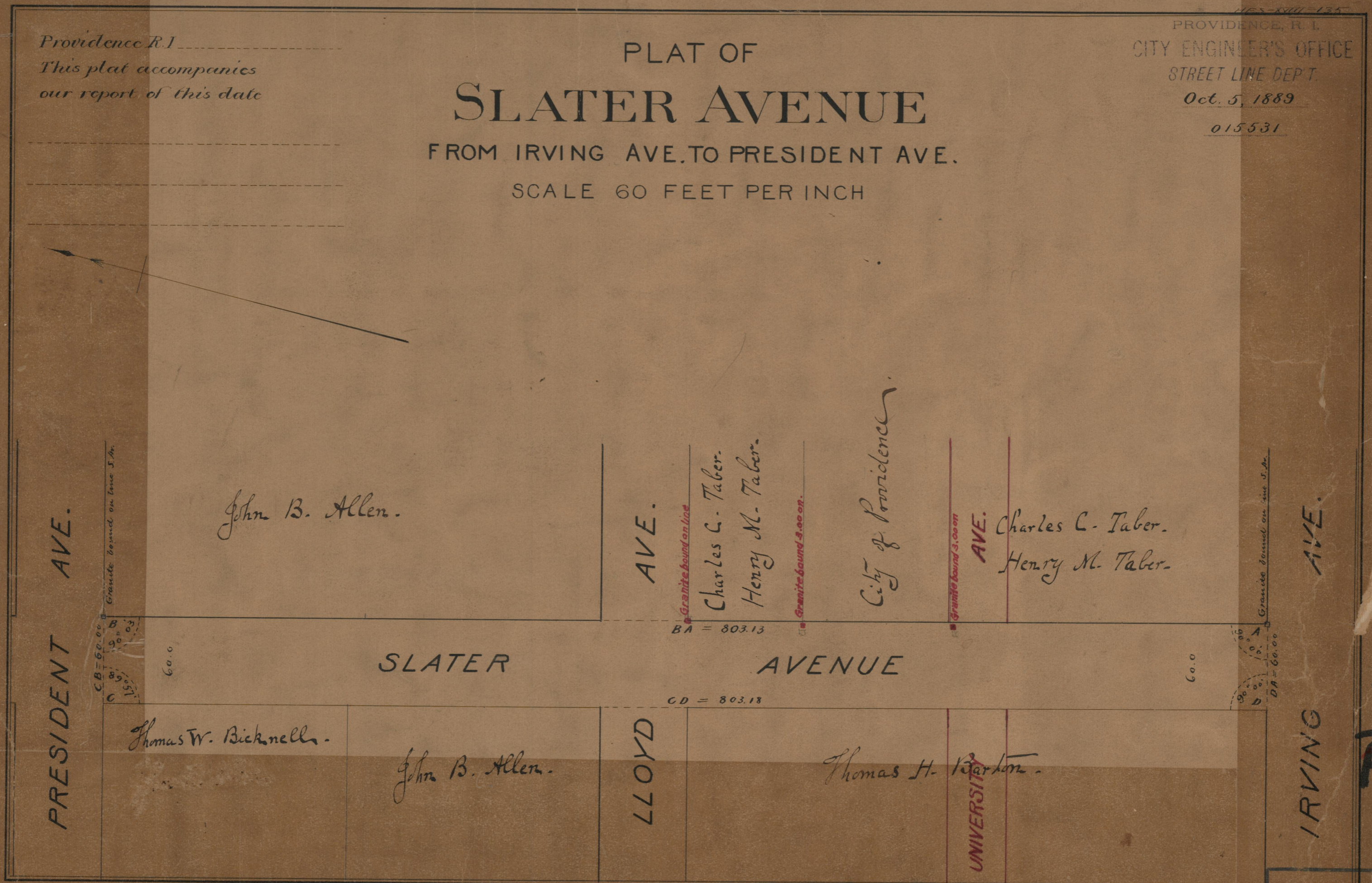

85
A-22

OFFICE No. 102
DRAWER
SHEET A-22

85A22