

PROVIDENCE, R. I. .
CITY ENGINEER'S OFFICE
STREET LINE DEPT.

Aug 7, 1889

015341

Providence R.I.
This plat accompanies
our report of this date

PLAT OF
THAYER STREET
FROM BENEVOLENT ST. TO TRANSIT ST.

IN TWO SHEETS

SCALE 50 FEET PER INCH

1532.66

BENEVOLENT ST.

ST.

ST.

THAYER STREET

CHARLESFIELD

POWER

85

A-15

85
A-15

OFFICE No. 10090
DRAWER " 85
SHEET " A-15

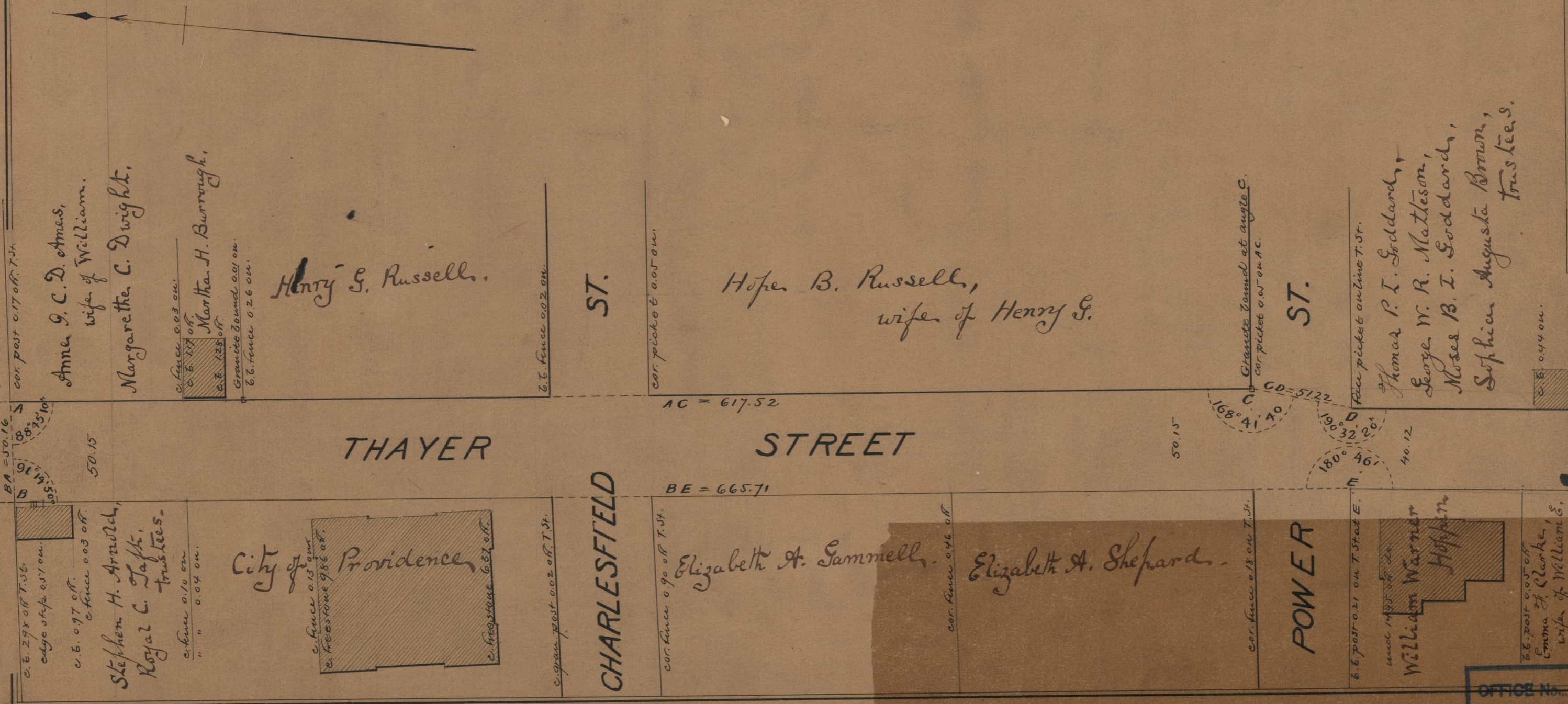

170, 113.0
54, 90.13
267.56 30

E. B. 33 East of range AC.

BENEVOLENT

cor. post 0.17 off. T. St.
Anne G. C. D. Ames,
wife of William.
Margaretta C. Dwight.
c. fence 0.03 on.
E. B. 117 off
Martha H. Burroughs.
E. B. 128 off
Granite bound 0.01 on.
E. B. fence 0.26 on.

Henry G. Russell.

E. B. fence 0.02 on.
cor. picket 0.05 on.

Hope B. Russell,
wife of Henry G.

Granite bound at angle C.
cor. picket 0.07 on AC.
face picket online T. St.
Thomas P. I. Goddard,
George W. R. Matteson,
Moses B. I. Goddard,
Sophia Augusta Brown,
Trustees.
E. B. 0.44 on.
E. B. 0.34 on.

BA = 50.16
179.72
8° 35' 10\"/>

c. b. 2.98 off T. St.
edge steps 0.51 on.
c. b. 0.97 off.
c. fence 0.03 off.
Stephen H. Arnold,
Royal C. Laffin,
Trustees.
c. fence 0.10 on
" " 0.04 on.

City of Providence
c. fence 0.13 on
c. freestone 9.86 off.
c. freestone 6.67 off.

c. green post 0.02 off. T. St.

cor. fence 0.90 off T. St.
Elizabeth A. Sammel.

cor. fence 0.46 off.
Elizabeth A. Shepard.

cor. fence 0.13 on T. St.
William Warner
Hoffman
c. b. post 0.05 off
Emma J. Clarke,
wife of William S.

50.15
168° 41' 40\"/>

70.12
180° 46'
190° 32' 26\"/>