

G.W.S. 3431-81-5  
F.B.B. XVII 170-1 & Plat Card

PROVIDENCE, R.I.  
CITY ENGINEER'S OFFICE

STREET LINE DEPT.

Sept. 12, 1894.

023039

PLAT OF  
**WASHINGTON AVENUE**

FROM MARYLAND AVE. TO BROAD ST.

IN TWO SHEETS

SCALE 60 FEET PER INCH

1801.55

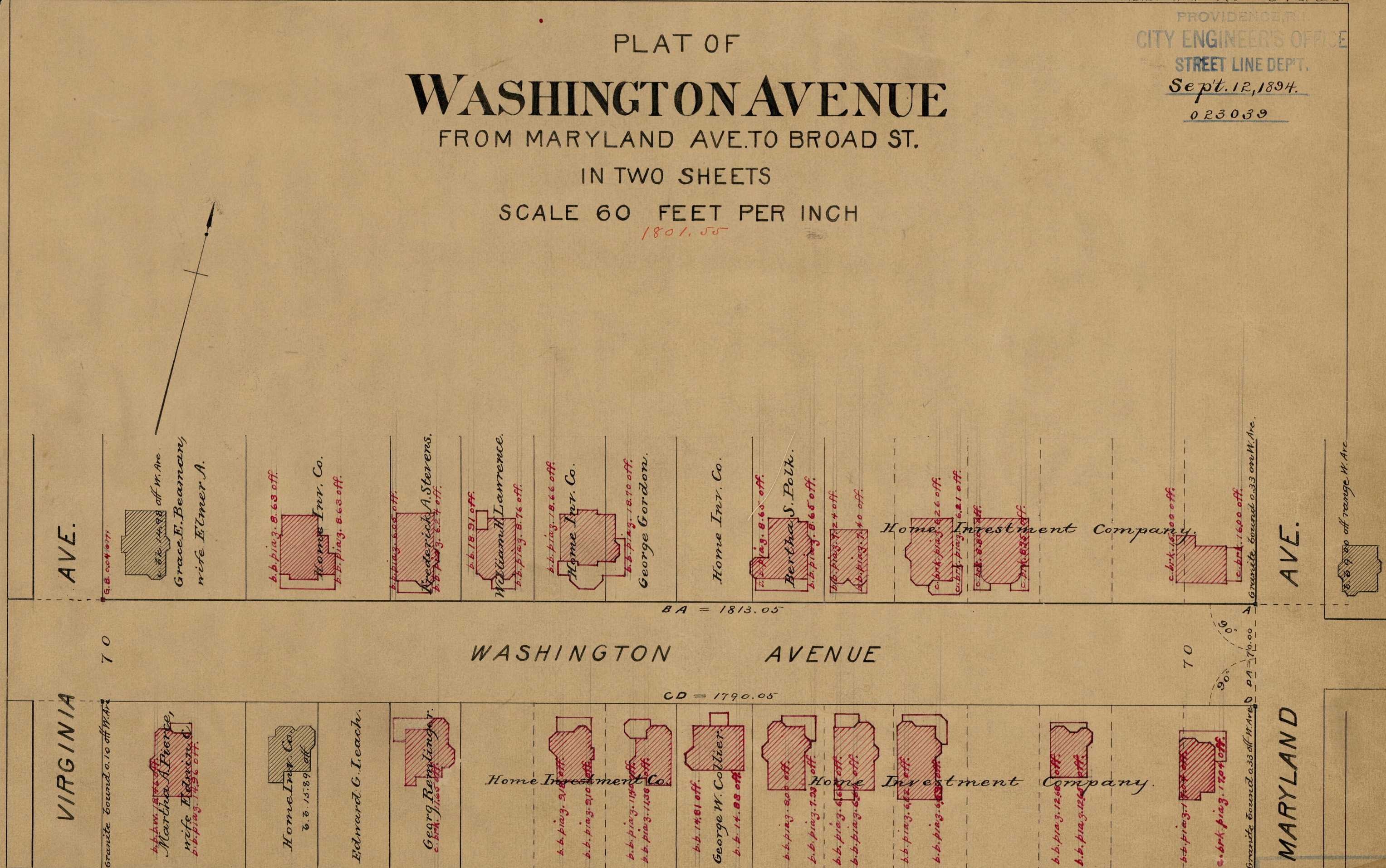

AVE.

G.B. 0.04 off.

off W. Ave.  
Grace E. Beaman,  
wife Elmer A.

b.b. plat. 8.63 off.  
Home Inv. Co.

b.b. plat. 6.05 off.  
Frederick A. Stevens.

b.b. 18.91 off.  
William H. Lawrence.

b.b. plat. 78.66 off.  
Home Inv. Co.  
George Gordon.

Home Inv. Co.

b.b. plat. 8.65 off.  
Bertha S. Polk.

b.b. plat. 7.24 off.  
b.b. plat. 74.0 off.

c. brk. plat. 22.6 off.  
Home Investment Company.

c. brk. plat. 6.21 off.  
c. brk. 8.00 off.  
c. brk. 8.35 off.

c. brk. 15.00 off.  
c. brk. 16.00 off.

Granite bound 0.33 on W. Ave.

AVE.

b.b. 9.80 off range W. Ave.

VIRGINIA

Granite bound 0.10 off W. Ave.

b.b. plat. 12.76 off.  
Martha A. Pierce,  
wife Edmundo C.

Home Inv. Co.  
b. b. 15.89 off.

Edward G. Leach.

c. brk. 11.05 off.  
Georg Remlinger.

Home Investment Co.

b.b. plat. 2.16 off.

b.b. plat. 2.10 off.  
b.b. plat. 11.94 off.  
b.b. plat. 11.08 off.

b.b. 14.61 off.  
George W. Collier.

b.b. plat. 5.06 off.

b.b. plat. 7.33 off.

b.b. plat. 6.65 off.

b.b. plat. 6.64 off.

b.b. plat. 6.72 off.

b.b. plat. 6.30 off.

Home Investment Company.

b.b. plat. 12.66 off.

b.b. plat. 12.66 off.

b.b. plat. 1.70 off.

c. brk. plat. 1.70 off.

Granite bound 0.33 off W. Ave.

MARYLAND

OFFICE No. 12339  
DRAWER 84  
SHEET B-67