

PROVIDENCE, R.I.
CITY ENGINEER'S OFFICE

STREET LINE DEPT.

Sept. 12, 1894.

023023

PLAT OF INDIANA AVENUE

FROM MARYLAND AVE. TO EDDY ST.

INTWO SHEETS

SCALE 60 FEET PER INCH

1735.28

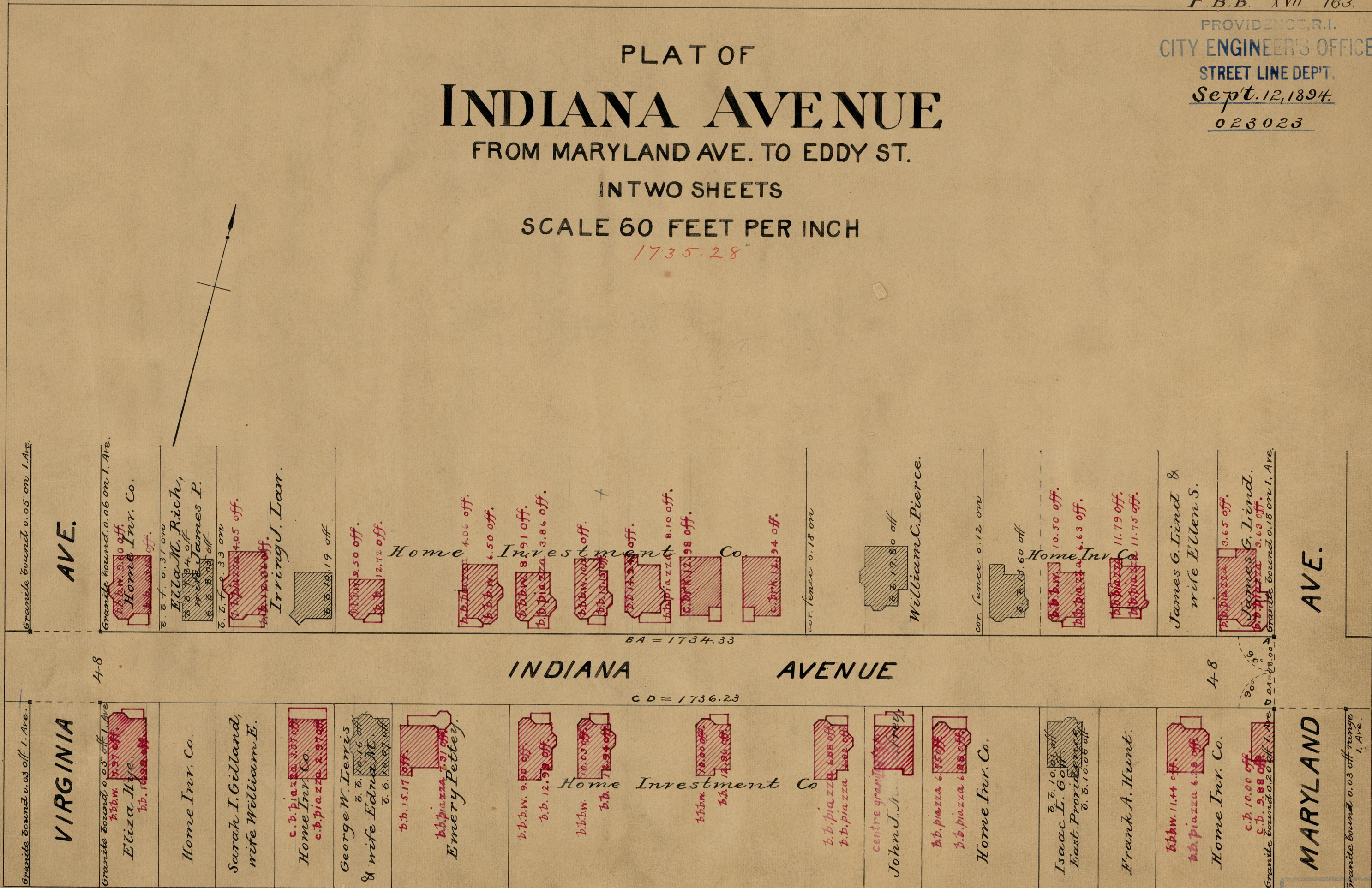
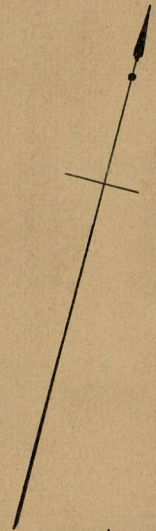

Granite bound 0.05 on I. Ave.

AVE.

Granite bound 0.06 on I. Ave.

Home Inv. Co.
4.10 off.

Ella M. Rich,
wife James P.
4.34 off.

Irving J. Lan.
4.05 off.

9.50 off.

12.72 off.

4.06 off.

6.50 off.

8.91 off.

3.86 off.

off.

8.10 off.

12.98 off.

12.94 off.

con. fence 0.18 on

William C. Pierce.
6.19, 8.0 off.

con. fence 0.12 on

Home Inv Co.
6.29, 6.0 off.

10.50 off.

11.79 off.

11.75 off.

James G. Lind &
wife Ellen S.
3.65 off.

James G. Lind.
8.63 off.

Granite bound 0.18 on I. Ave.

AVE.

Granite bound 0.03 off I. Ave.

VIRGINIA

4-8
Granite bound 0.03 off I. Ave.
Eliza Hye
1.37 off.

Home Inv. Co.

Sarah I. Gillard,
wife William E.
c.b. piazza 2.97 off.

George W. Lewis
& wife Edna M.
c.b. 1.16 off.

Emery Petter.
b.b. piazza 1.31 off.

Home Investment Co.
b.b. 1.15, 1.17 off.

9.50 off.

12.98 off.

off.

7.26 off.

Home Investment Co.
b.b. 1.15, 1.17 off.

John J. ...
centre granite

Home Inv. Co.
b.b. piazza 6.17, 5.9 off.

Isaac I. Go.
East Providence
b.b. 1.0, 1.0 off.

Frank A. Hunt.

Home Inv. Co.
b.b. 1.14 off.

Home Inv. Co.
c.b. 10.00 off.

Granite bound 0.20 off I. Ave.

MARYLAND

Granite bound 0.03 off range I. Ave.

OFFICE No. 12331
DRAWER 84
SHEET B-59

84
B-59