

Note The letters ABCDEFGHIJ
indicate the area dedicated.

PROVIDENCE, R.I.
CITY ENGINEER'S OFFICE
STREET LINE DEPT.

Feb. 8, 1894

022130

MAP OF FRANCIS STREET

FROM GASPEE ST. TO B & P. R. R. LAND
DEDICATED FOR HIGHWAY PURPOSES
BY RESOLUTION OF THE CITY COUNCIL

December 28, 1893

SCALE 100 FEET PER INCH.

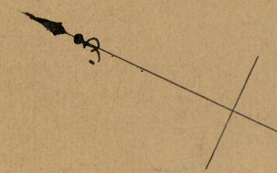

9462
23855
11847

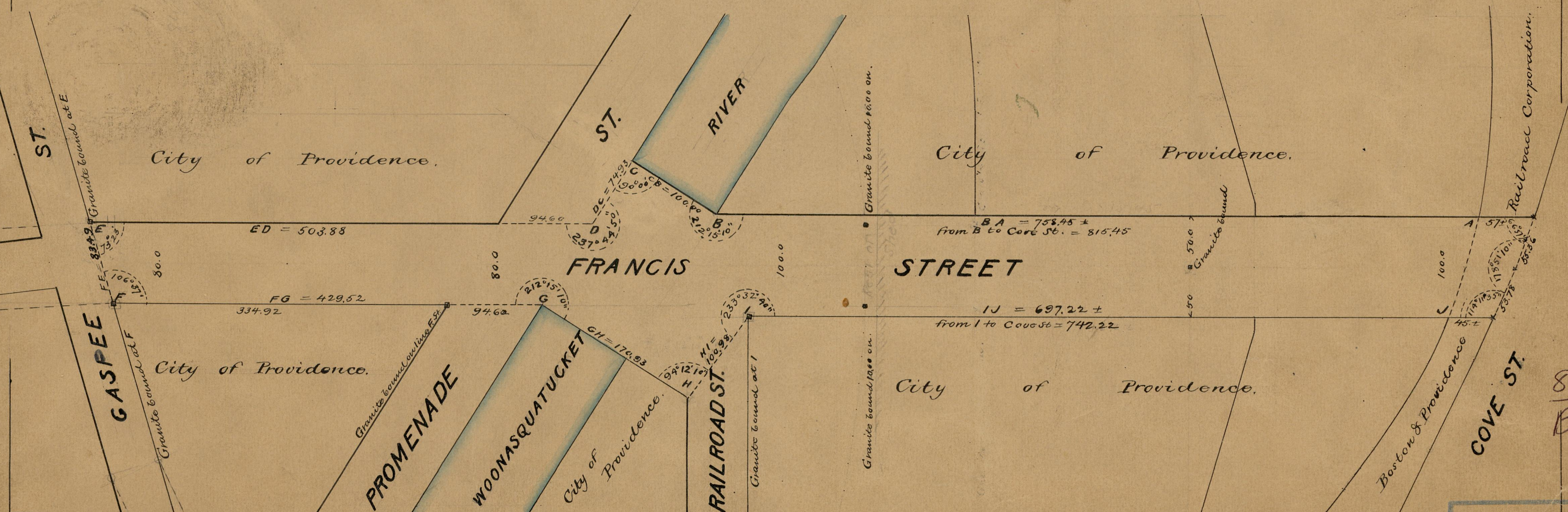

84
B-30
84
B-30

OFFICE No. 12006
DRAWER " 84
CHECK