

PROVIDENCE, R.I.
CITY ENGINEER'S OFFICE
STREET LINE DEPT.

Aug 25 1893

021432

PLAT OF
FOREST STREET

FROM CAMP ST. TO EAST AVE.

IN TWO SHEETS.

SCALE 50 FEET PER INCH.

1134.67

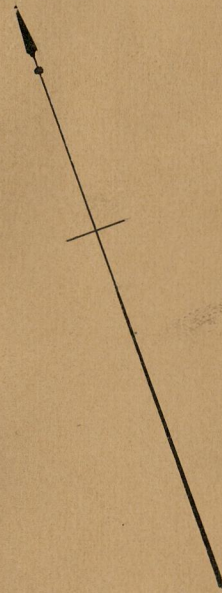

ST

Estate of John Wilson Smith

Estate of John Wilson Smith

cor. fence 2.22 off F. St.

DA = 106.33
DB = 106.33
DC = 106.33
50

AB = 1137.58

b. b. f. on line

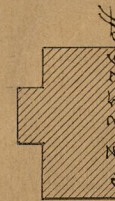

post. 0.36 on F. St.

ST.

cor. post. 0.05 on F. St.

c. b. 24.82 off "

CAMP

part 2.02 on F. St.

Estate of John Wilson Smith

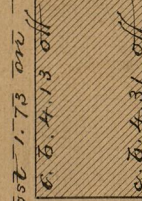

post 1.73 on c. b. 4.13 off c. b. 4.31 off

Estate of Parley M. MacIntyre

Estate of John Wilson Smith

cor. post. 0.71 on

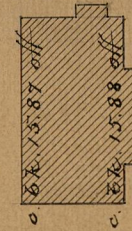

James L. Crowell

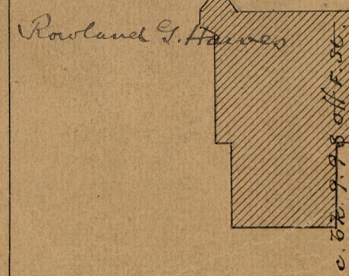

Rowland G. Hawley

c. b. 7.96 off F. St.

IVY

b. b. f. 0.13 on F. St.



c. b. 11.06 off "

OFFICE No. 11852
DRAWER 84
SHEET B-2