

Note. The area dedicated is indicated by the letters A, B, C, D, E, F, G, H and I.

PROVIDENCE, R.I.
CITY ENGINEER'S OFFICE
STREET LINE DEPT.
Feb. 27, 1893.
020576

PLAT
OF LAND BELONGING TO THE
CITY OF PROVIDENCE
DEDICATED FOR HIGHWAY PURPOSES
BY RESOLUTION OF THE
CITY COUNCIL

December 3, 1892,
SCALE 80 FEET PER INCH.

Gaspee St.

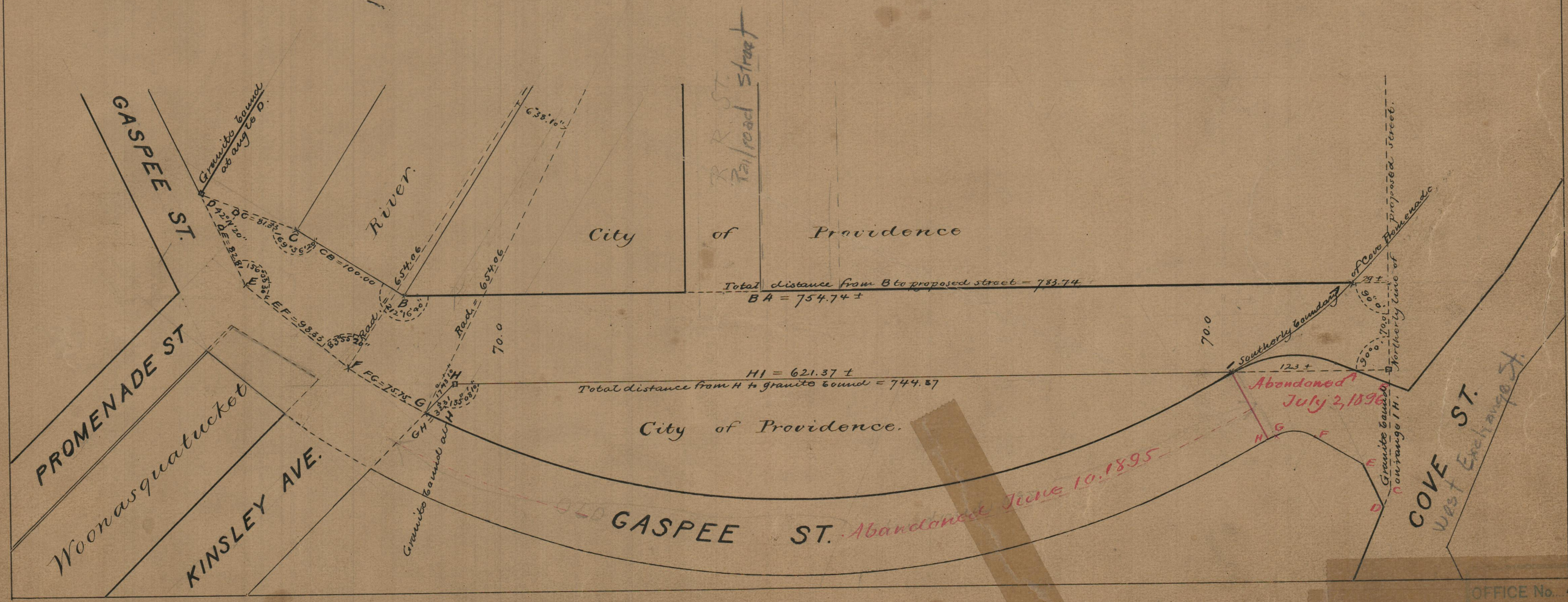

OFFICE No. 116
DRAWER

84
A-73