

PLAT OF
PLAIN STREET

FROM PAVILION AVE. TO BROAD ST.

IN FOUR SHEETS

SCALE 50 FEET PER INCH.

PROVIDENCE, R.I.
CITY ENGINEER'S OFFICE
STREET LINE DEPT.

June 16, 1893.

021035

Changed to Rugby St. Mar. 15, 1894.

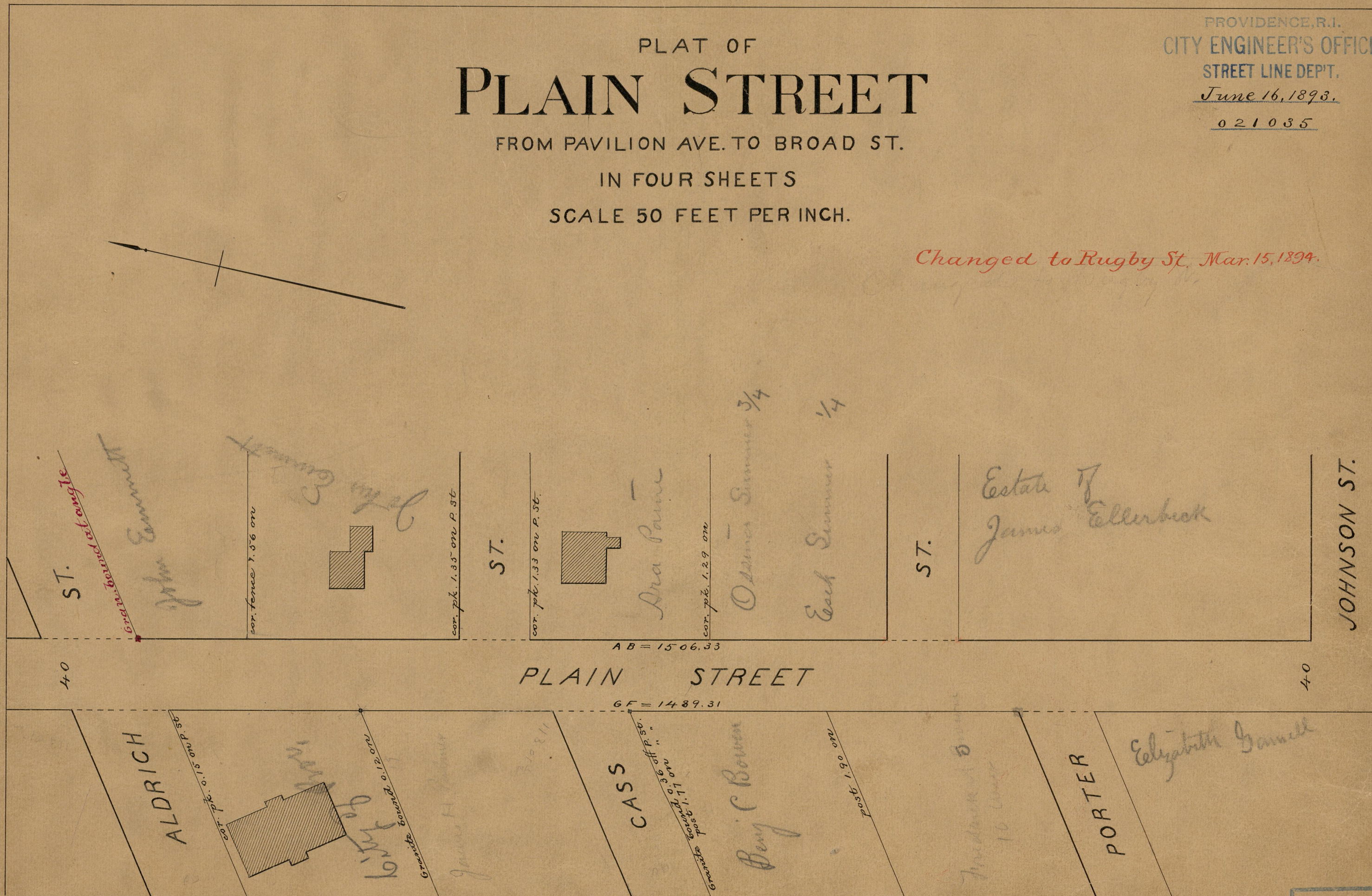

*84
A-86*

84
A-86

OFFICE No.	1	721
DRAWER	4	
SHEET	9	86