

PROVIDENCE, R.I.
CITY ENGINEER'S OFFICE
STREET LINE DEPT.

Apr. 7, 1893.

020747

Note, The lines given agree with
plat of Francis Street presented
to the board of aldermen Dec. 17 1896.

PLAT OF FRANCIS STREET

FROM GASPEE ST. TO SMITH ST.

IN TWO SHEETS.

SCALE 50 FEET PER INCH.

Showing widening as agreed to by the
State of Rhode Island
and the Board of State House Commissioners.

Notes in red
were added Dec 11, 1896.

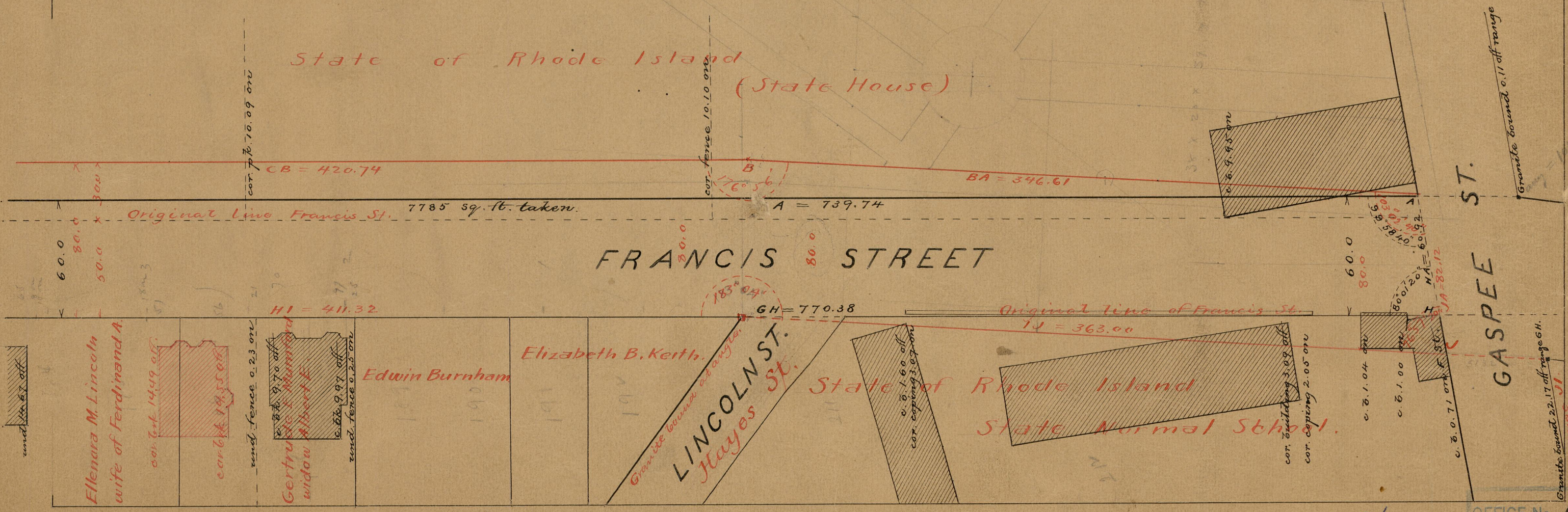
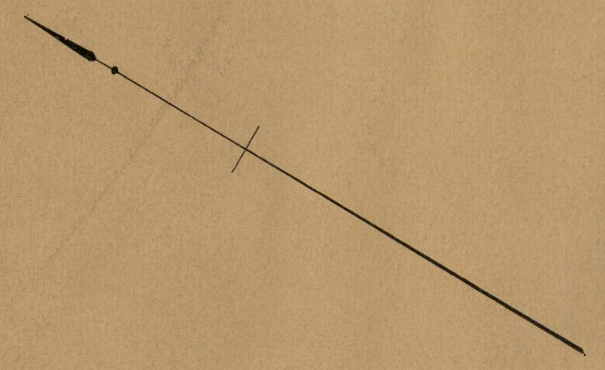

A-80

OFFICE No. 11675
DRAWER " 84
SHEET " 1-80