

Note. The area dedicated is indicated by the letters A, B, C, D, E, F, G, H and I.

PROVIDENCE, R.I.  
 CITY ENGINEER'S OFFICE  
 STREET LINE DEPT.  
 Feb. 27, 1893.  
 020576

PLAT  
 OF LAND BELONGING TO THE  
**CITY OF PROVIDENCE**  
 DEDICATED FOR HIGHWAY PURPOSES  
 BY RESOLUTION OF THE  
**CITY COUNCIL**

December 3, 1892,  
 SCALE 80 FEET PER INCH.

*Gaspee St.*

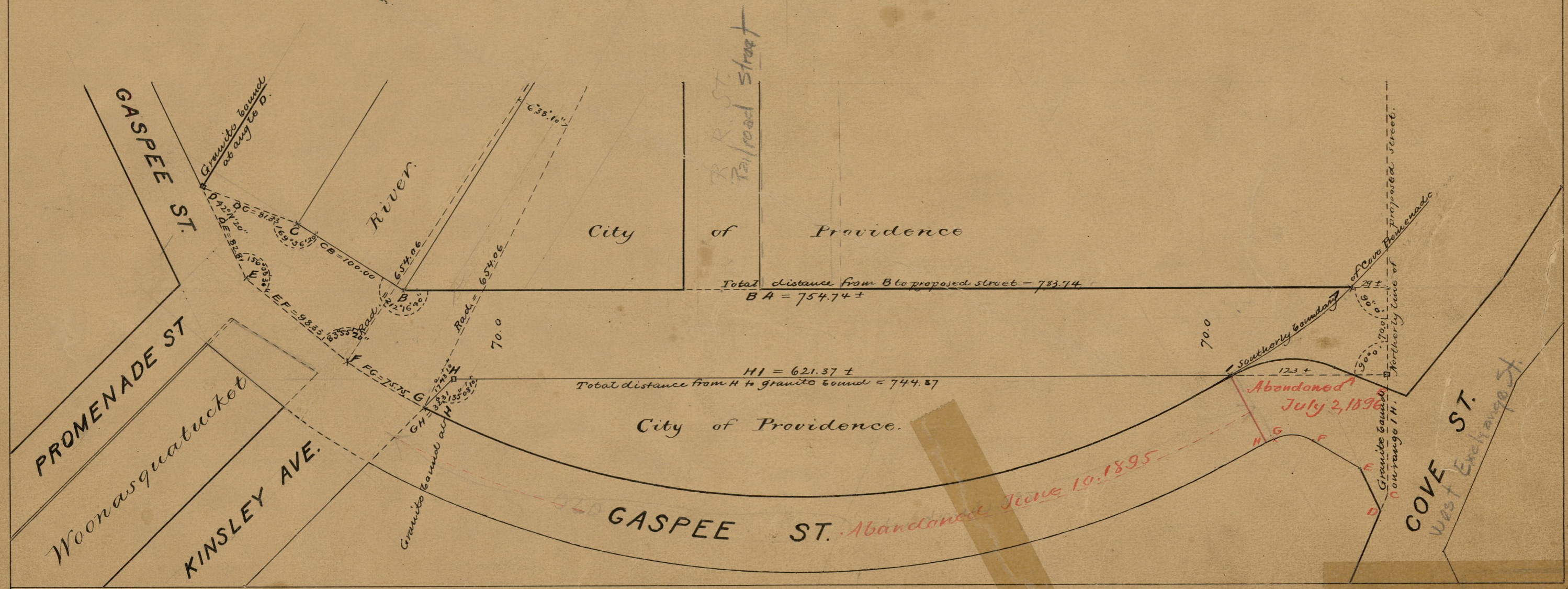

OFFICE No. 116  
 DRAWER

84  
 A-73