

PROVIDENCE, R.I.
CITY ENGINEER'S OFFICE
STREET LINE DEPT.
Dec. 28, 1892.

020428

CANTON STREET

FROM REGENT AVE. TO CHALKSTONE AVE.

IN TWO SHEETS.

SCALE 40 FEET PER INCH.

1002.53

Providence R.I.
This plat accompanies
our report of this date.

CHALKSTONE AVE.

CEYLON ST.

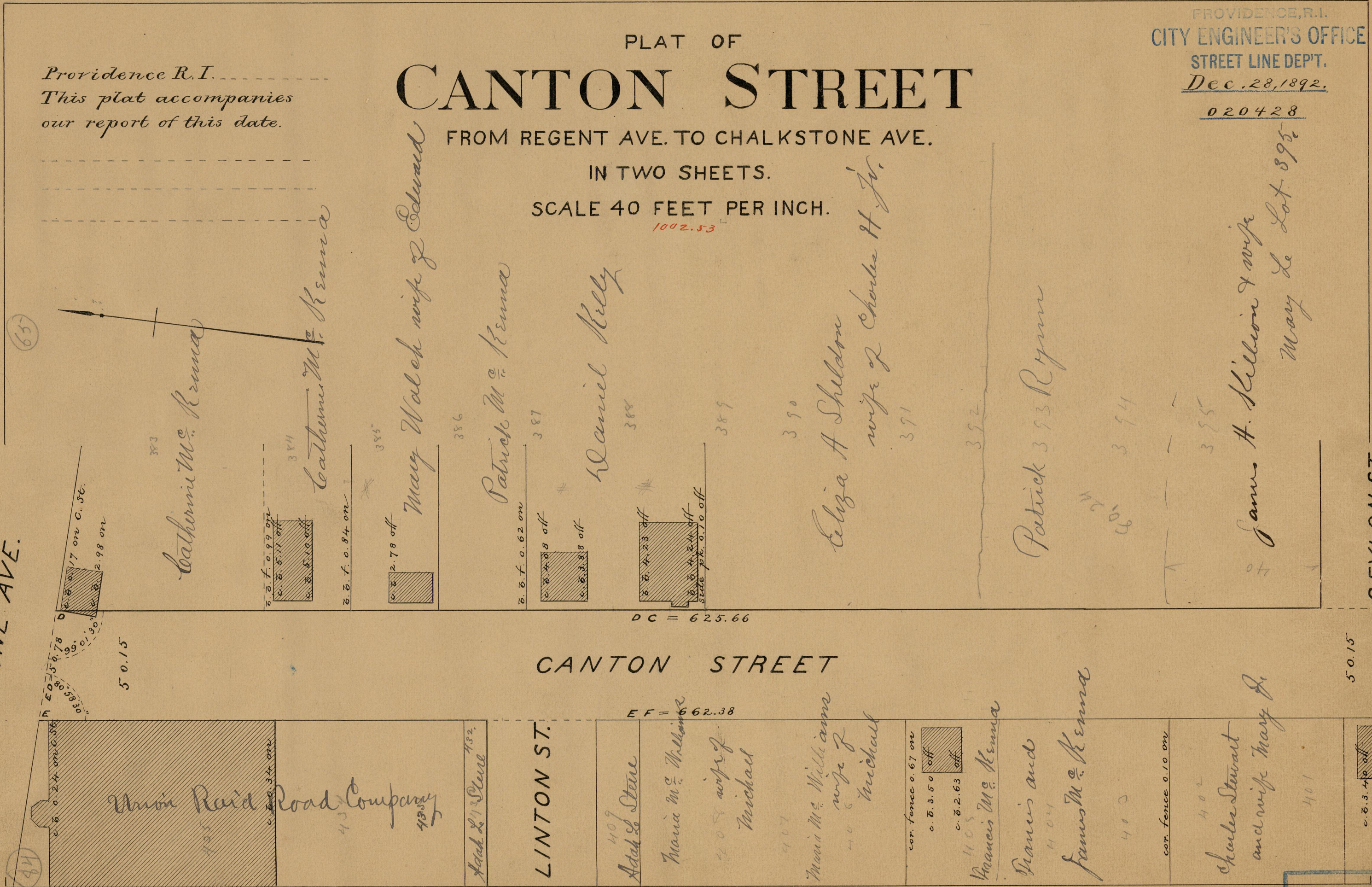

Catharine M^e. Kenne

Catharine M^e. Kenne

Mary Walsh wife of Edward

Patrick M^e. Kenne

Daniel Kelly

Eliza A Sheldon
wife of Charles H. Jr.

Patrick Ryan

James H. Killon & wife
May de Lot 395

Union Road Company

Arch L. Stone

LINTON ST.

Arch L. Stone

Maria M^e. Williams
wife of
Michael

Maria M^e. Williams
wife of
Michael

Francis M^e. Kenne

Francis and

James M^e. Kenne

Charles Stewart
and wife Mary J.

OFFICE No. 11555
DRAWER 84
A-67