

# MAP OF PECK ST. FROM WEYBOSSET ST. TO DYER ST. IN 3 SHEETS.

City Engineer's Office  
November 30, 1877  
Scale 20 feet per inch.

COMPARED.

*Wm. D. Brewster*  
Ass't Engineer.

*Note: red figures refer to line as adopted*

STREET LINE DEPT.  
Nov. 30, 1877  
04153

OFFICE NO. 343  
DRAWER " 82

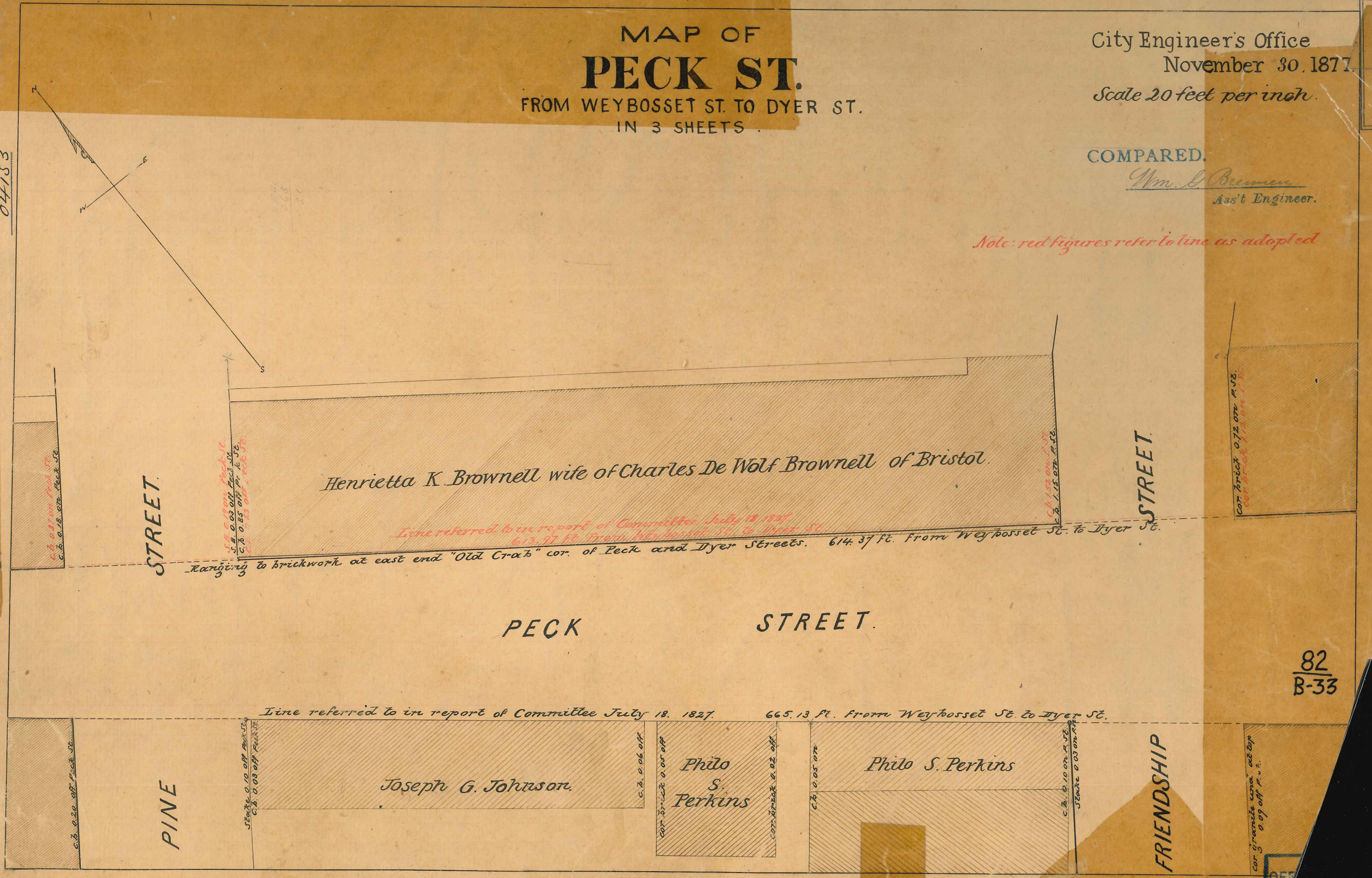

*Henrietta K. Brownell wife of Charles De Wolf Brownell of Bristol.*

*Line referred to in report of Committee July 18, 1827.  
613.97 ft. from Weybosset St. to Dyer St.*

*614.37 ft. from Weybosset St. to Dyer St.  
Ranging to brickwork at east end "Old Crab" cor. of Peck and Dyer Streets.*

PECK STREET.

*Line referred to in report of Committee July 18, 1827. 665.13 ft. from Weybosset St. to Dyer St.*

*Joseph G. Johnson.*

*Philo S. Perkins*

*Philo S. Perkins*

PINE STREET.

FRIENDSHIP STREET.

82  
B-33

*Cor. granite wind. at top  
0.09 off P. SE.*

*C.B. 0.37 on P. SE  
C.B. 0.18 off P. SE*

*S.B. 0.16 on Peck St.  
S.B. 0.03 off Peck St.  
C.B. 0.85 off P. SE  
C.B. 0.13 on P. SE*

*C.B. 1.52 on P. SE  
C.B. 1.15 off P. SE*

*Cor. brick 0.72 on P. SE  
Cor. brick 1.13 on P. SE*

*C.B. 0.20 off P. SE*

*Stake 0.10 off Peck St.  
C.B. 0.08 off Peck St.*

*C.B. 0.06 off*

*Cor. brick 0.05 off*

*Cor. brick 0.02 off*

*C.B. 0.05 on*

*C.B. 0.10 on P. SE  
Stake 0.03 on P. SE*