

Copy of 04623

PROVIDENCE, R.I.
CITY ENGINEER'S OFFICE
STREET LINE DEPT.

April 15, 1915

040841

Providence R.I.
This map accompanies our
report of this date.

MAP OF TRANSIT ST.

FROM GOVERNOR ST. TO THE HARBOR LINE.

ON SEEKONK RIVER
IN TWO SHEETS.

Scale 50 ft. per inch.

COMPARED.

Frederic Gladding
Asst. Engineer.

Changed to East Transit Street.

Jan. 20, 1891

----- } Committee.

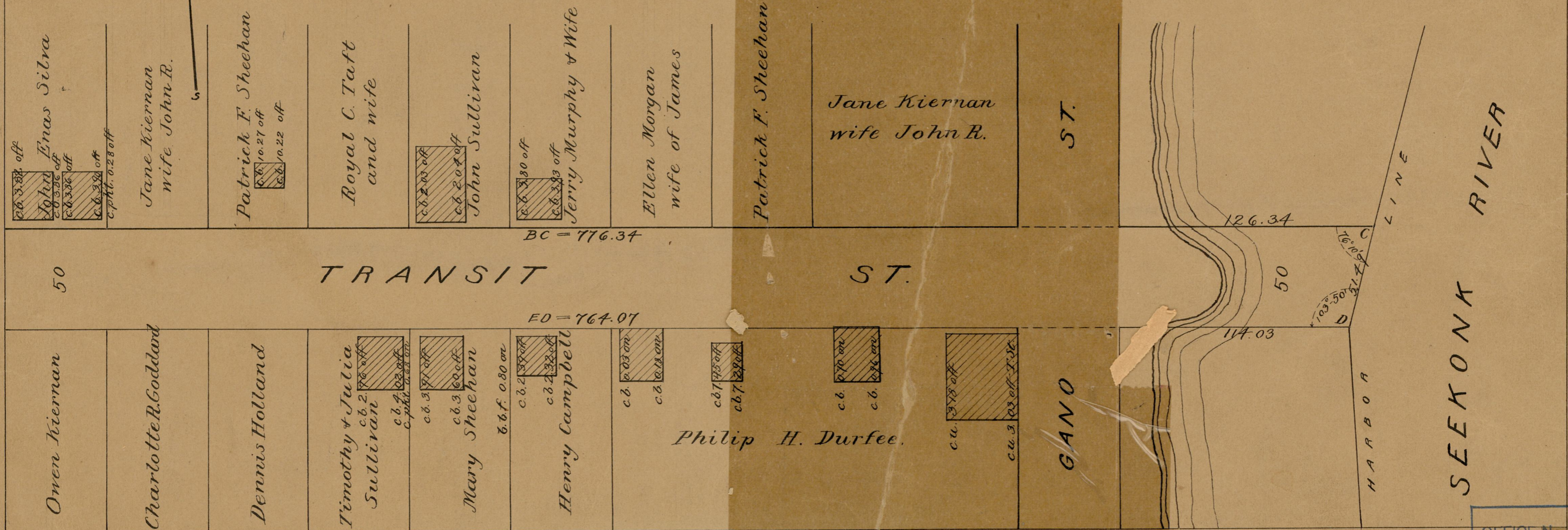
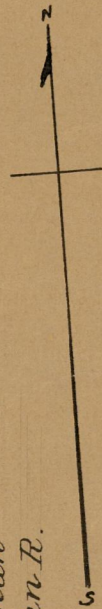

OFFICE No.	3816
DRAWER	82
SHEET	B-59