

# MAP OF PRAIRIE AVE.

FROM DUDLEY ST. TO THURBERS AV.

IN 7 SHEETS.

City Engineer's Office  
Apr. 1878 Nov. 1877

Scale 50 ft per inch.

COMPARED.

Wm. G. Brennen.  
Asst Engineer.

CITY ENGINEER'S OFFICE.  
STREET LINE DEPT.

Apr. 1878  
04357

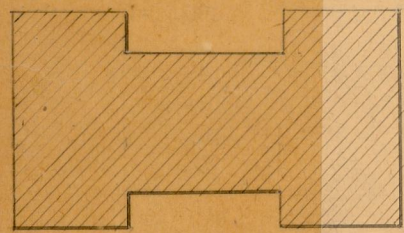

R. I. Catholic  
Orphan Asylum

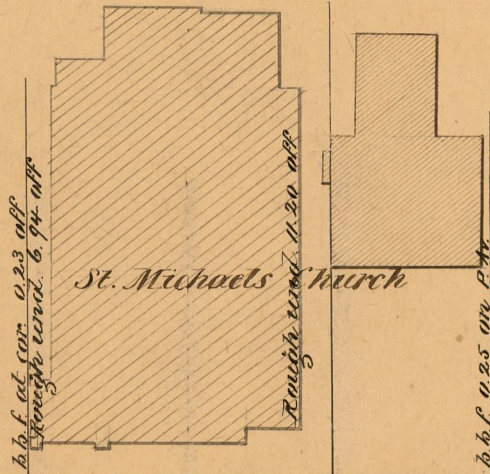

St. Michael's Church

STREET

Michael A.  
Wallace

Geo. W. Steere (Gloucester) 1/3  
Andrew J. Steere " 1/3  
Oliver W. Steere " 1/3

cap. brick 8.50 off  
Francis & Rachel Co.  
Hazony

cap. brick 8.02 off

b.b.p. 0.37 off

cap. brick 8.21 off

John Reichsala

cap. brick 8.24 off

b.b.p. 0.04 in

John Bannon

cap. brick 3.28 off  
Catherine Bannon  
Wife of Peter

cap. brick 2.91 off

cap. brick 1.36 off

STREET

b.b.p. 0.32 off P.A.V.

cap. brick 7.36 off

cap. brick 7.08 off

Peter Huff

N. 6° 52' 30" W 1521.63 Ft. straight line from Gallup St. to Putters Av.

## PRAIRIE AVENUE

N. 6° 52' 30" W 1521.49 Ft. straight line from Gallup St. to Putters Av.

c.b. 8.12 off  
Geo. H. Gardner

c.b. 7.97 off  
b.b.p. 0.11 off

c.b. 10.0 off

Joseph Hill

Lyons Delaney 1/2

c.b. 10.14 off

b.b. fence 0.12 off

c.b. 10.28 off

John Connary

c.b. 10.02 off

b.b. fence 0.09 off

c.b. 10.16 off

Wm. Mariman

(Prairie Av.)

b.b. 10.22 off

b.b. fence on line

Francis M. Smith

OXFORD

c.b. 4.05 off

c.b. 4.04 off

c.b. 4.26 off

c.b. 4.27 off

Mary F. Page

Wife of Hiram F.

Benj. B. Adams

Nathan Greene

face of pickets 0.44 off

c.b. 3.07 off

r.b. 2.99 off

Thomas B. Morris

face of pickets 0.21 off

c.b. 3.85 off

c.b. 3.85 off P.A.V.

SAYLES

b.b. 0.40 off P.A.V.

b.b. fence on line P.A.V.

c.b. 4.98 off

c.b. 4.89 off

George T. Manchester

82  
B-40

OFFICE No. 3594  
DRAWER " 82  
SHEET " B-40

OFFICE No. 3594  
DRAWER " 82  
SHEET " B-40