

Aug. 1876
03453

11-2-80-81
H.F.S-3-80-81

Field St. extends from the western line of State St. as established by the B. & A. April 10 1848 to the eastern line of Davis St. as established by J. Currier Sept 11. 1826

MAP OF
FIELD ST.
from Davis St. to State St.
City Engineer's Office Aug. 1876

To be examined again

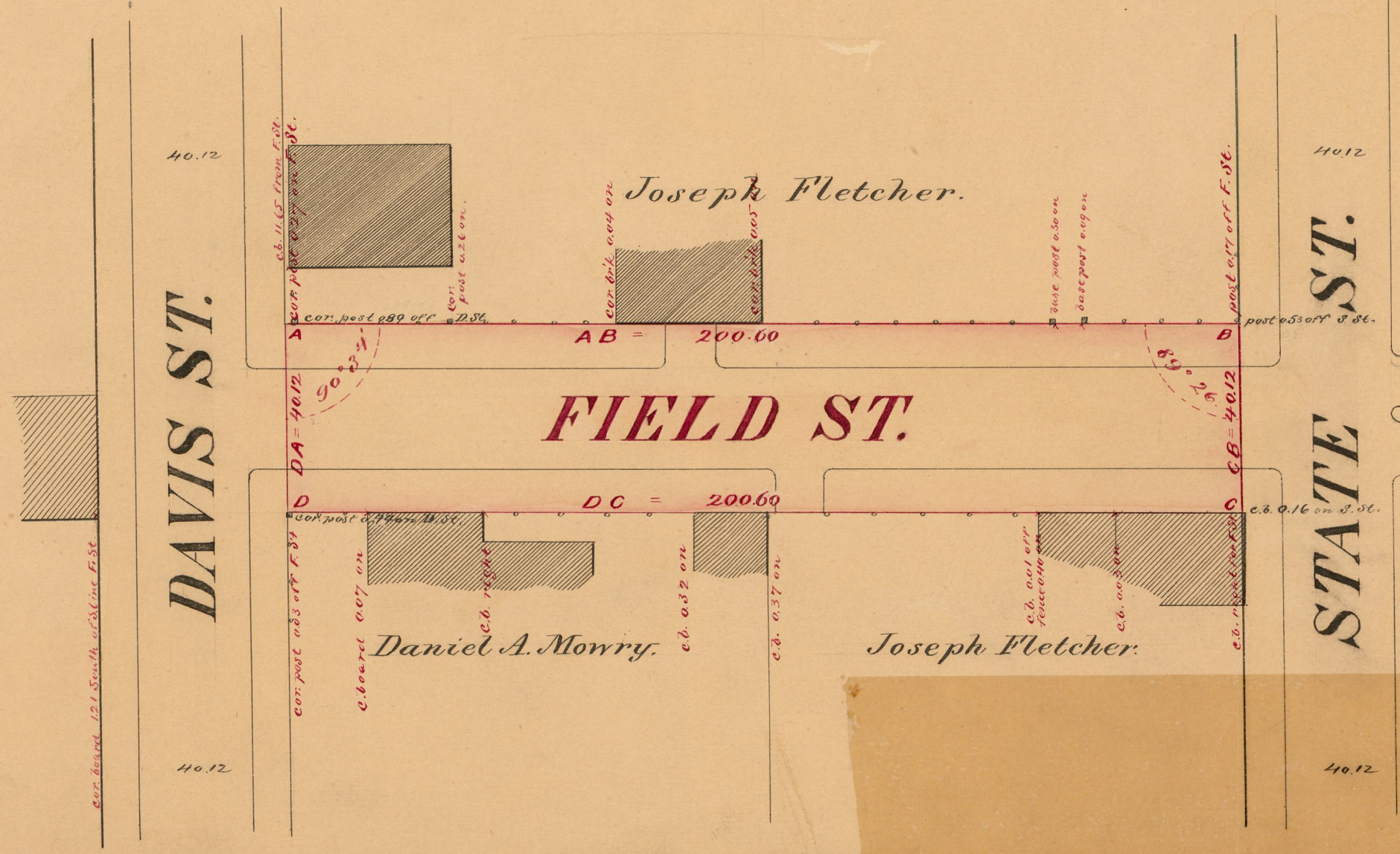

Charles E. Paine
Scale 30 feet to the inch.

OFFICE No. 2842
DRAWER " 82
SHEET " B-4

OFFICE No. 2842
DRAWER " 82
SHEET " B-4