

PROVIDENCE, R.I.  
CITY ENGINEER'S OFFICE  
STREET LINE DEPT.  
Aug 11, 1896  
025528

Note. The letters ABCD indicate the lines of Angell street as previously platted between the limits specified by the resolution.

PLAT OF  
**ANGELL STREET**

FROM GRAND AVE. TO BLACKSTONE PARK.

SCALE 50 FEET PER INCH.  
**ORDERED REPAIRED**  
**BY RESOLUTION OF THE**  
**BOARD OF ALDERMEN**  
May 21, 1896.

639.71  
634.88  
21274.59  
637.29

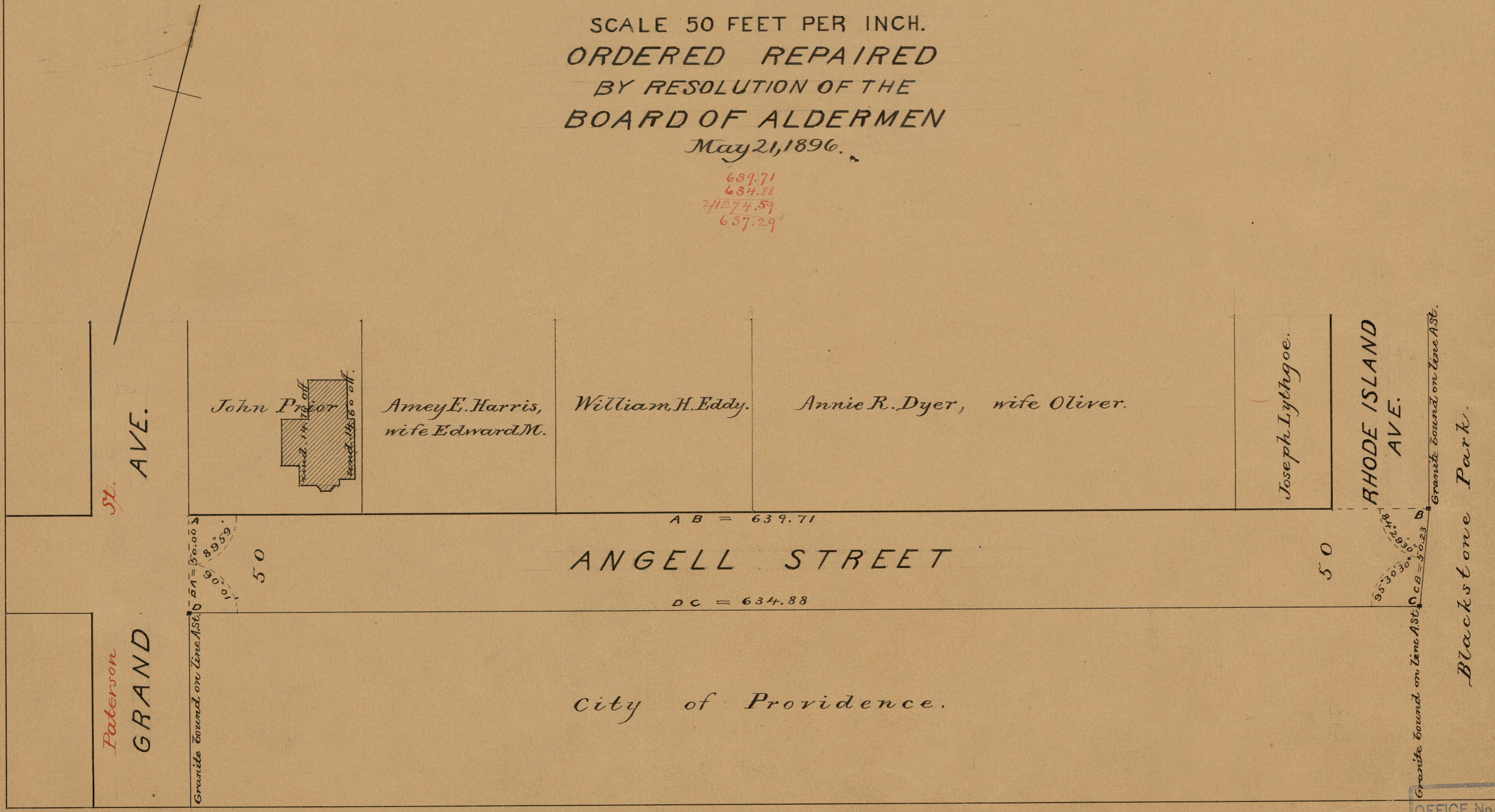

Granite bound on line Ast.  
Granite bound on line Ast.  
Blackstone Park.

82  
B 23

OFFICE No. 13020  
DRAWER 82  
SHEET B 23