

CITY ENGINEER'S OFFICE:
STREET LINE DEPT.

Sept. 1877
04065

Point Street

W613-3-371

MAP OF A **STREET** FROM
SOUTH WATER ST. TO THE HARBOR LINE
to connect with the Point St. Bri dge.

City Engineer's Office
September 1877.
Scale of 20 ft to one inch.

Named Point St.

COMPARED.
Wm. G. Brenner.
Asst Engineer.

OFFICE No. 3353
DRAWER " 88
SHEET " B-20

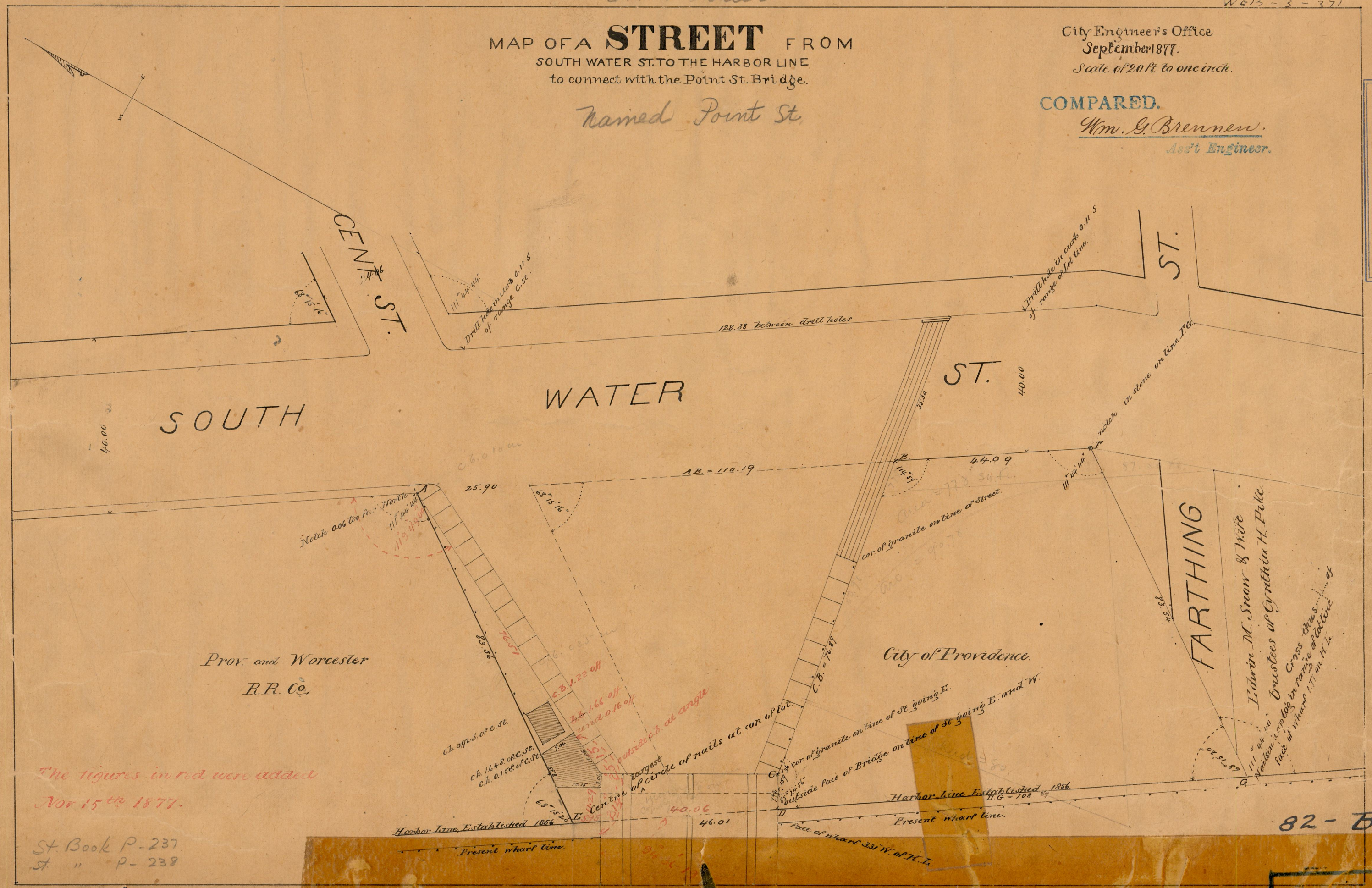

Prov. and Worcester
R.R. Co.

City of Providence.

J. Edwin M. Snow & Wife
Trustees of Cynthia H. Pike
Cross this
in range of lot
face of wharf 1.77 on N. E.

The figures in red were added
Nov 15th 1877.

St. Book P-237
St. " P-238

82-B20

OFFICE No. 3353