

W.G.B. 392-1006121

PROVIDENCE, R.I.  
CITY ENGINEER'S OFFICE  
STREET LINE DEPT.

Nov. 22, 1907

035398

Name in red added Mar. 16, 1883.

# MAP OF GEORGE STREET

FROM BENEFIT ST. TO GANO ST.  
IN 8 SHEETS

Scale 40 ft. per inch.

Providence R.I.

This Map accompanies our  
Report of this date

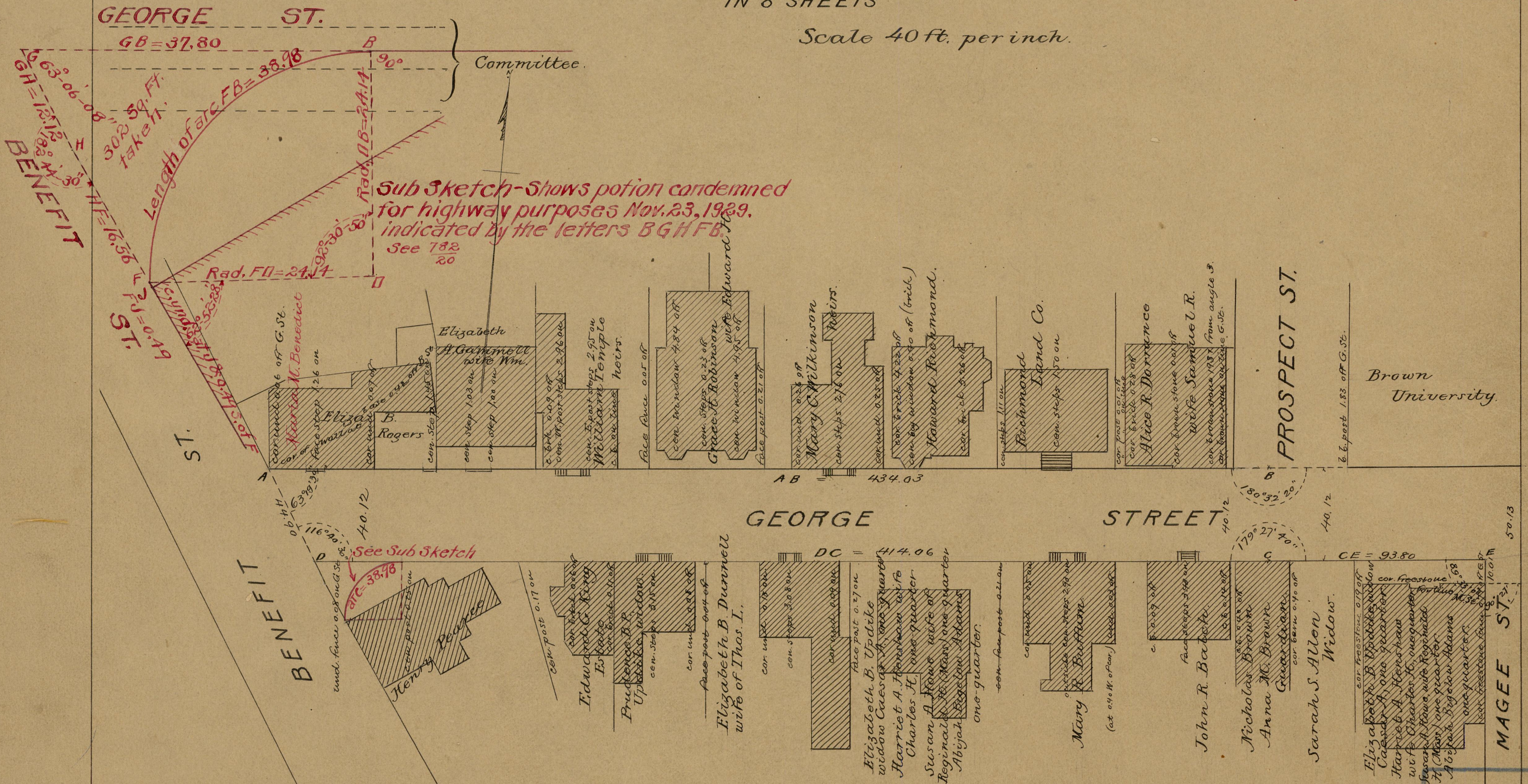

Sub Sketch - Shows portion condemned  
for highway purposes Nov. 23, 1909,  
indicated by the letters B G H F B.  
See 782  
20

GEORGE ST.  
GB = 37.80  
Length of arc FB = 38.98  
Rad. FB = 24.14  
90°  
Committee.  
Benefit St.  
GH = 12.18  
63° 06' 08" H  
HE = 16.56  
30° 59' 11" taken  
ST. = 19.0  
174° 06' 08" of F

BENEFIT ST.

GEORGE STREET

PROSPECT ST.

MAGEE ST.

Brown University

OFFICE No. 5215  
DRAWER 82  
SHEET A-79