

PROVIDENCE, R.I.
CITY ENGINEER'S OFFICE

STREET LINE DEPT.

Jan. 2, 1896.

024775

Note The lines shown correspond with the deed conveying certain streets to the city of Providence and recorded in deed book 196 page 177.

PLAT OF
ABORN STREET
FROM PRESENT TERMINATION TO WEST EXCHANGE ST.
SCALE 40 FEET PER INCH.

212.51
242.46
2454.97
227.48

82
A-42

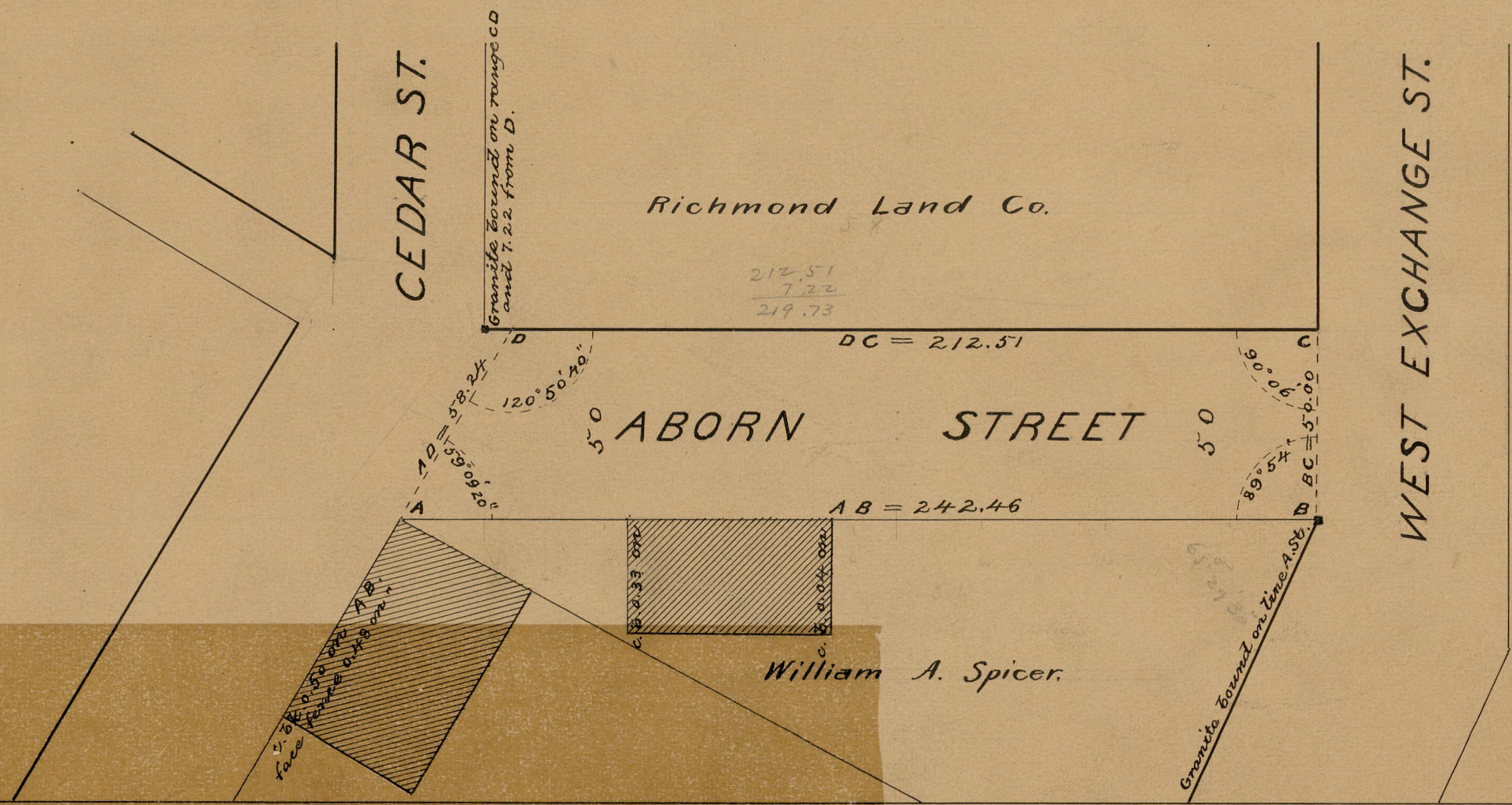
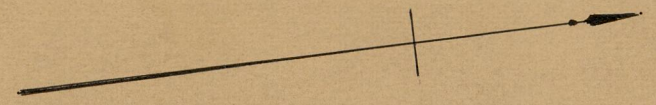

82
A-42

OFFICE No. 12745
DRAWER 83
SHEET A-42