

PROVIDENCE, R.I.
CITY ENGINEER'S OFFICE
STREET LINE DEPT.

June 24, 1915

041005

MAP OF

BAKER AVENUE

FROM HIGH ST. TO BROADWAY.

Scale 60 feet to an inch.

COMPARED.

Fredric A. Gladding
Asst Engineer.

New Bainbridge Ave

Changed to Bainbridge Ave. Dec. 7, 1899.

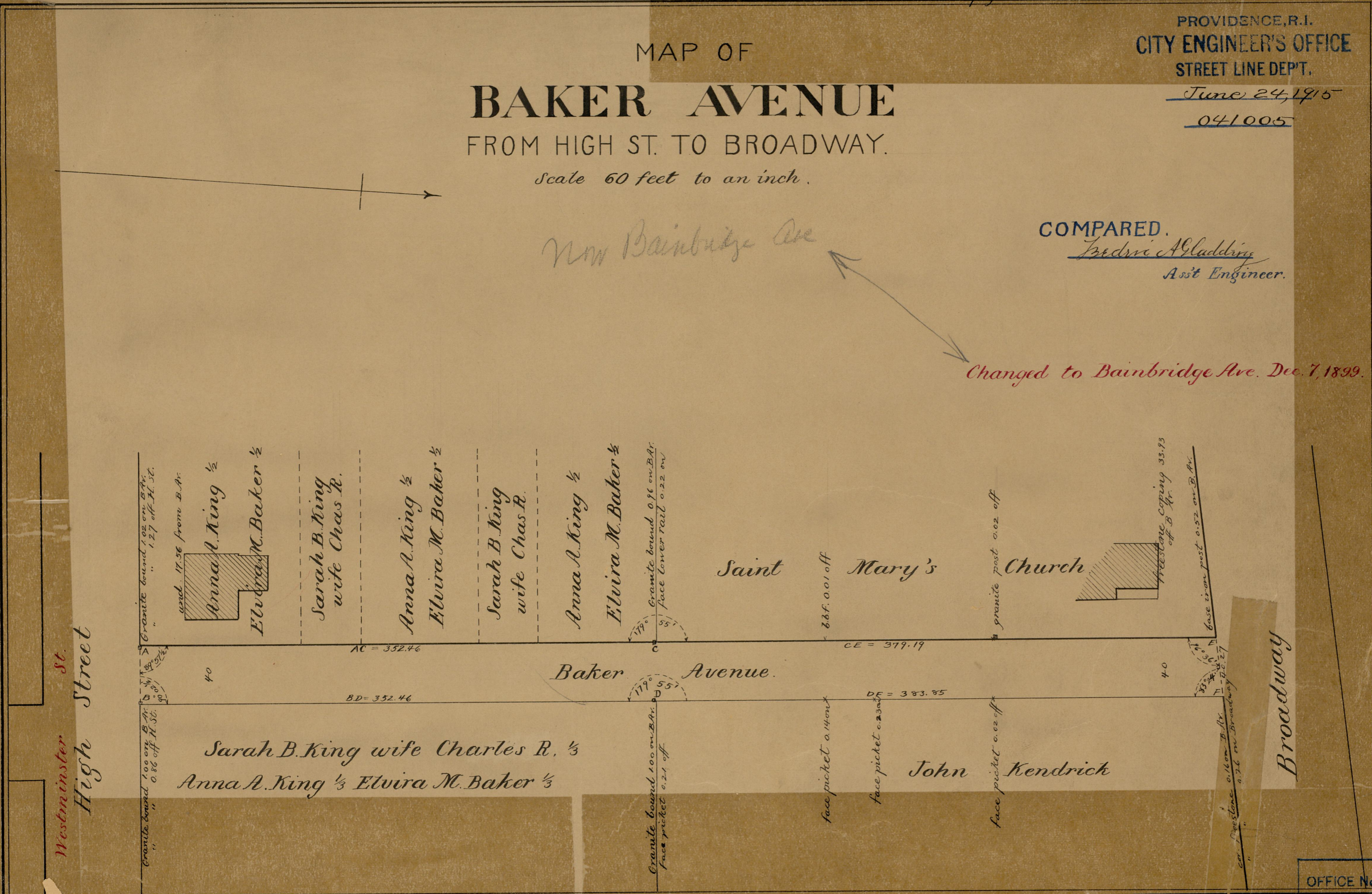

OFFICE No. 4001
 DRAWER 82
 SHEET A-2

82
A-2