

PLAT OF
ROSLYN AVENUE

FROM PORTION ALREADY RECEIVED TO EATON ST.

SCALE 60 FEET PER INCH

*Declared and Established a public highway by Resolution
of the Board of Aldermen
April 16, 1925*

PROVIDENCE, R.I.
CITY ENGINEER'S OFFICE
STREET LINE DEPT.
April 7, 1932
054425

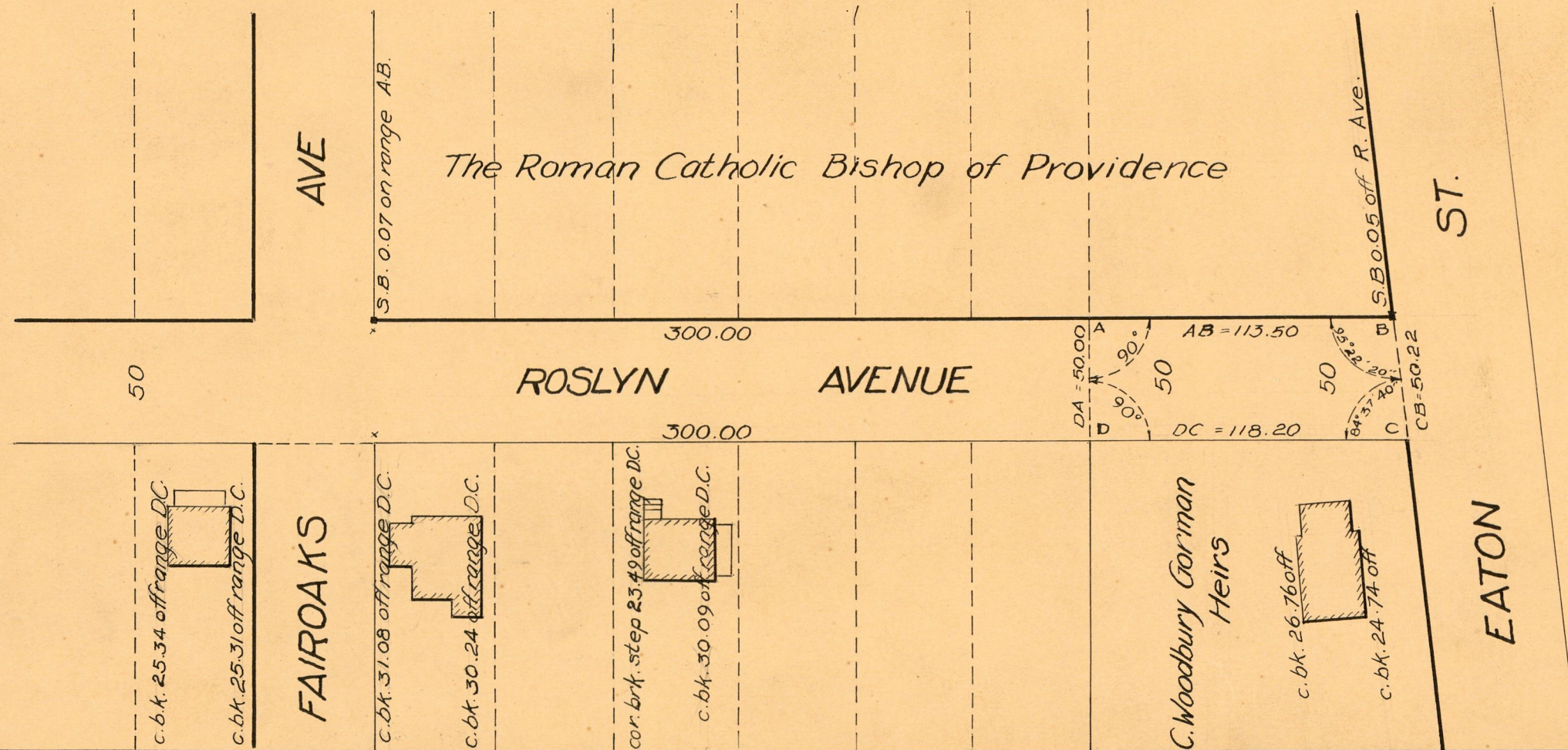

OFFICE No.	22997
DRAWER	81
SHEET	J-94