

SHEET ONE

PROVIDENCE, R.I.
CITY ENGINEER'S OFFICE
STREET LINE DEPT.
Jan. 26, 1925.
047586

NOTE:- The area declared a Public Highway is denoted by the letters ABCD and conforms with Joint Resolution of City Council No. 384 approved November 7, 1917.

PLAT OF
SMITHFIELD AVENUE

FROM MOSHASSUCK RIVER TO CEMETERY ST.

IN TWO SHEETS

SCALE 80 FEET PER INCH

DECLARED A PUBLIC HIGHWAY BY RESOLUTION

OF THE BOARD OF ALDERMEN

DECEMBER 4, 1924.

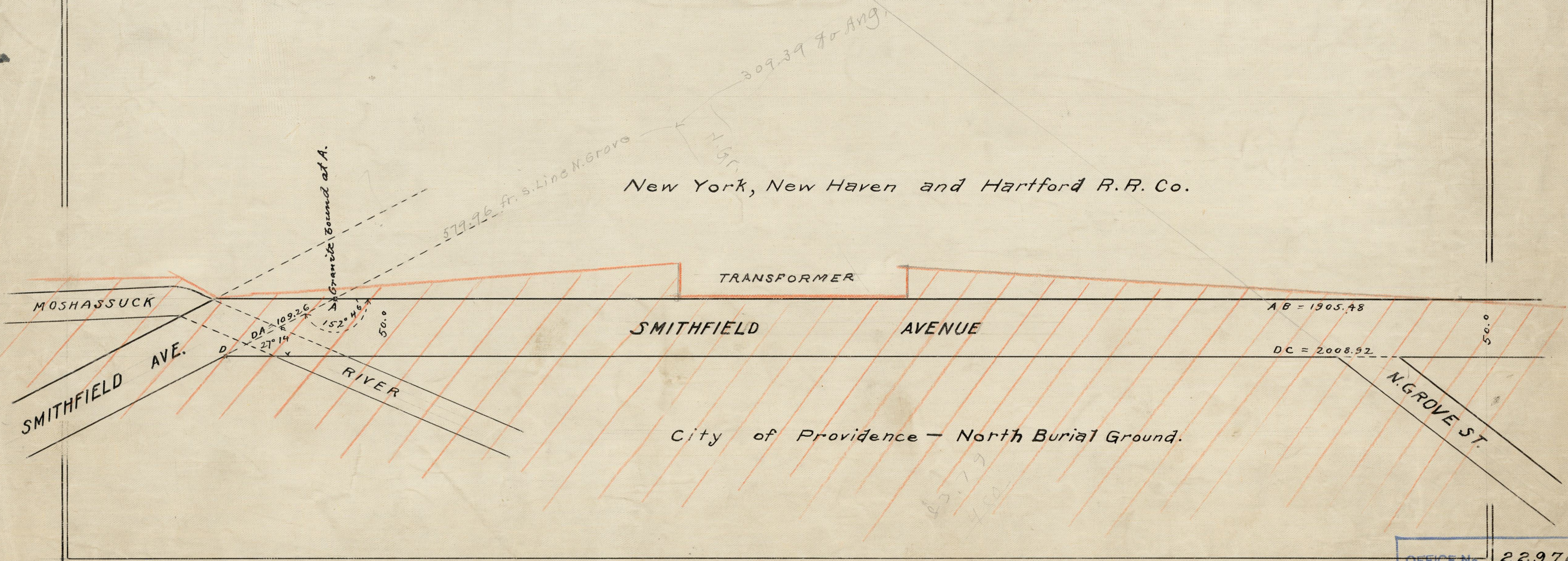
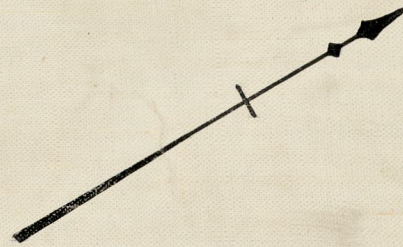

OFFICE No.	22976
DRAWER	81
SHEET	J-82