

PROVIDENCE, R.I.
CITY ENGINEER'S OFFICE
STREET LINE DEPT.
Dec. 31, 1924.

047477

PLAT OF
ALVIN STREET
FROM CRESCENT ST. TO DOWNING ST.
SCALE 80 FEET PER INCH

ESTABLISHED AND DECLARED A PUBLIC HIGHWAY
BY RESOLUTION OF THE BOARD OF ALDERMEN

DEC. 18, 1924.

983.64
969.30
2)1952.94
976.77

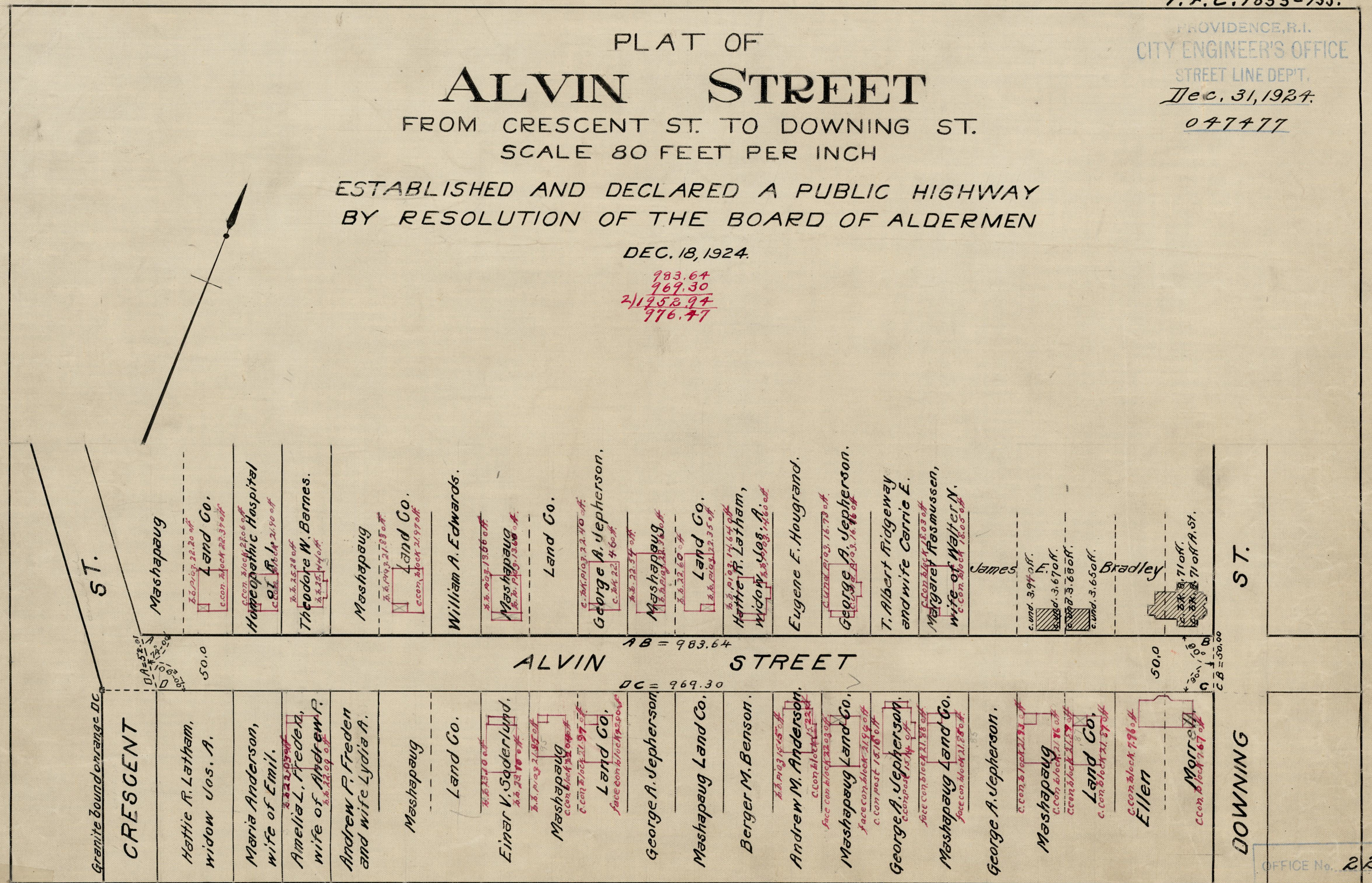
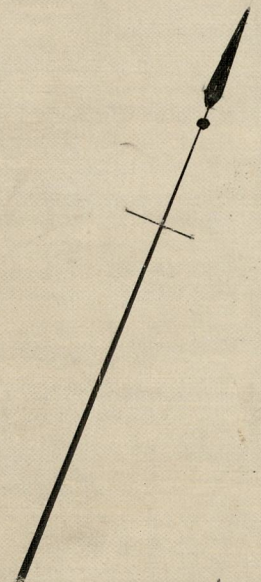

ST.

ALVIN STREET

DOWNING

OFFICE No. 22885
DRAWER 81
SHEET J-71