

T.F.C. 2352-4-7

PROVIDENCE, R.I.
CITY ENGINEER'S OFFICE
STREET LINE DEPT.

Oct 11, 1923.

046540

Note: The area established and declared a public highway is indicated by the letters ABCDE.

The lines thus fixed conform to the deeds recorded in Deed Book 431, page 8, Deed Book 498, page 246, Deed Book 507, page 304 and to the "Plain Farm Plat" recorded on card 853 in the office of the Recorder of Deeds.

PLAT OF WALLACE STREET

FROM WEBSTER AVE. TO TERRACE AVE.

SCALE 80 FEET PER INCH

ESTABLISHED AND DECLARED

A PUBLIC HIGHWAY BY RESOLUTION

OF THE BOARD OF ALDERMEN

August 2, 1923.

936.47
923.32
21859.79
929.895

Witness _____
City Clerk,

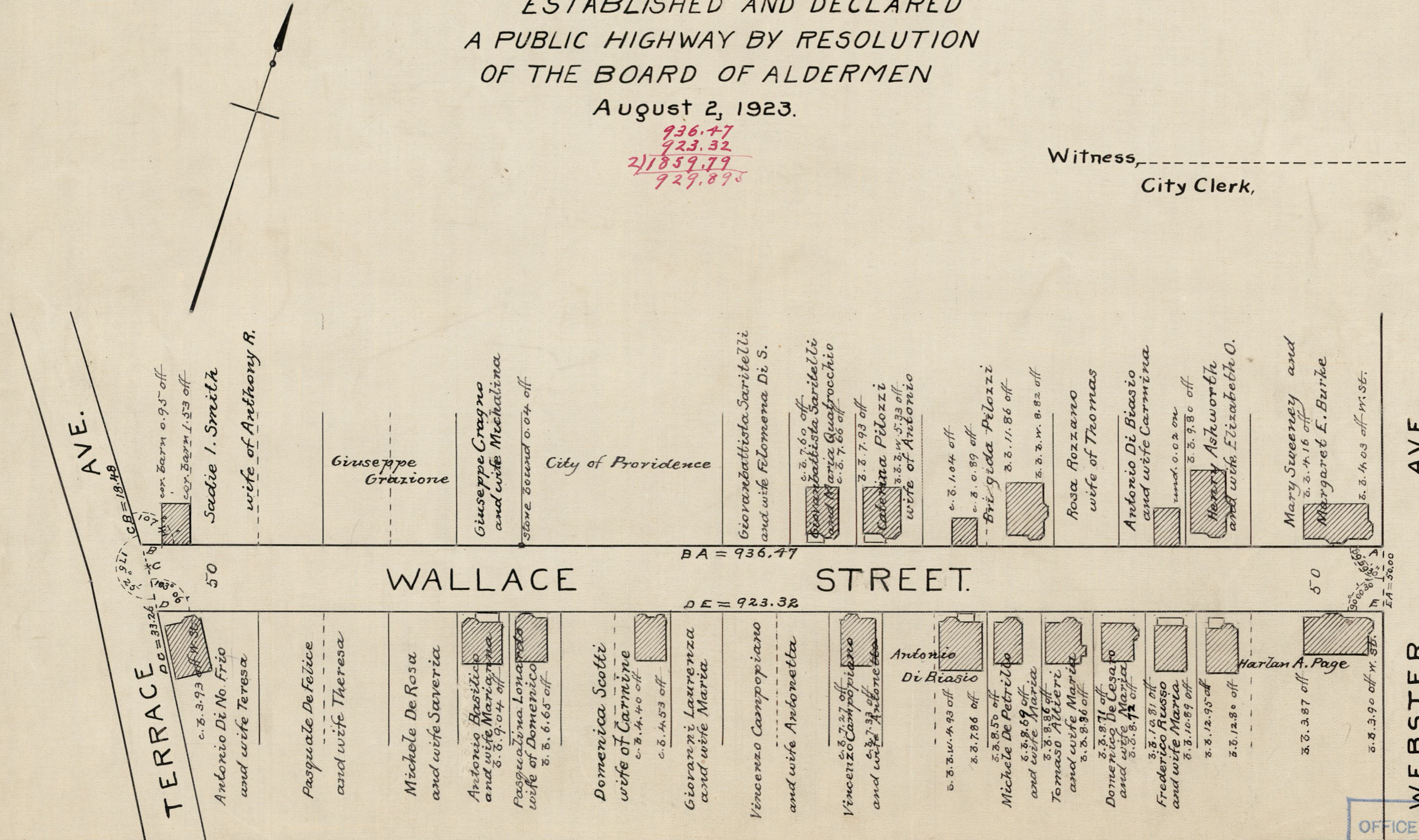

OFFICE No. 22574
DRAWER 81
SHEET J-36