

PROVIDENCE, R.I.
CITY ENGINEER'S OFFICE
STREET LINE DEPT.

Oct 3, 1922

045946

NOTE The area declared a public highway is indicated by the letters A-B-C-D-E. The lines thus defined agree with the deeds recorded in Deed book 410, page 78, Deed book 455 page 64, Deed book 557, page 197 and also with the plats entitled "Blackstone Park" recorded on plats 63 and 64 in the office of the Recorder of Deeds.

PLAT OF LORING AVENUE

FROM PRESIDENT AVE. TO THE SUMMIT ABOUT 250 FT. NORTHERLY SCALE 40 FEET PER INCH

Declared a Public Highway by Resolution of the Board of Aldermen Sept. 7, 1934

Witness ----- City Clerk -----

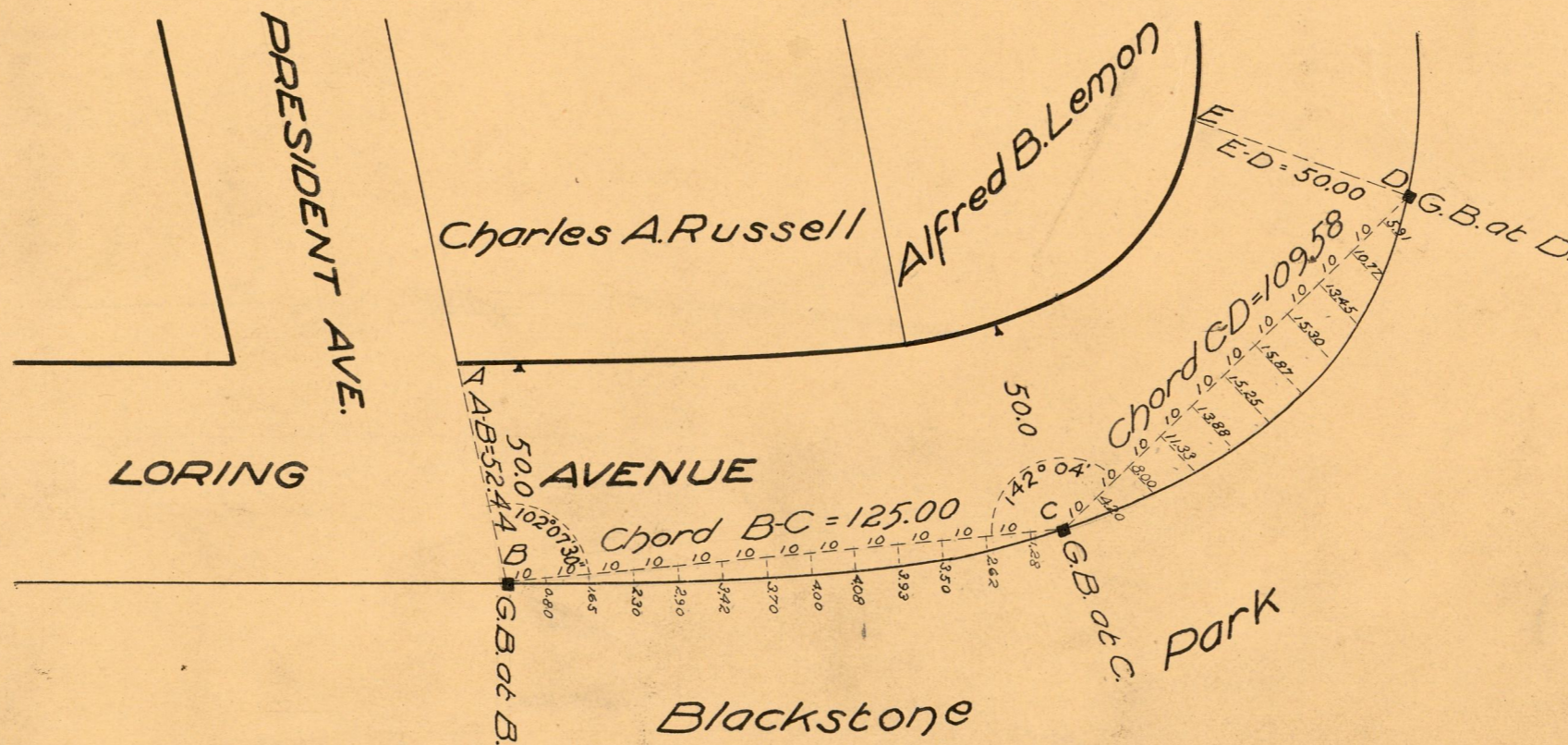
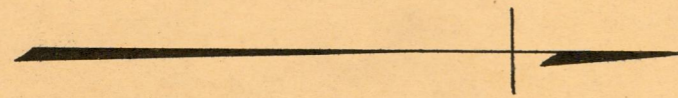

OFFICE No.	19708
DRAWER #	81
SHEET #	J-15